



50" Curved LED Light Bar Mount 2009-2015 Dodge Ram 1500 2010-2015 Dodge Ram 2500/3500

NOTE: Please read instructions before beginning installation. Check all of the kit's hardware to ensure it has all the proper contents. Be sure you have all needed parts and know where they go.

Contents of Kit: Driver and Passenger side mount, (2) Gaskets, (2) templates, (4) riv-nuts, (4) Stainless Allen head bolts

Tools needed: A center punch, cutters, a Drill, various drill bits up to 23/64", 5/16" wrench or socket, 3/8" wrench or a Riv-Nut tool (recommended), 4mm Allen key, silicone, permanent marker, a second person (recommended)

Installation Instructions:

1. Start by cutting out the templates. On the driver's side of the truck, line up the shaded portion over the top of the A-pillar molding.
2. At the end of the template make a mark on the molding.



3. Giving a firm tug on the A-pillar's (top of windshield) molding, it will release from the top clips.
4. Pull the rubber molding back to where previously marked and cut at that mark.



5. Lay the template on the base of where the molding was removed and line it up with the corner of the windshield. Mark both holes with a center punch.
6. Drill a pilot hole where previously marked with a 5/64" drill bit, then slowly work up to a 23/64" drill bit.



7. Take the supplied 5/16" x 1" bolt, washer, and 3/8" nut and screw them into the nut insert.



8. Apply a small amount of silicone to the splined area of the riv-nut.
9. Insert supplied riv-nut into the holes, flush with the metal.
10. Use a 5/16" wrench or socket to tighten the bolt while holding the nut with the 3/8" wrench. Doing this will compress the nut insert and lock it into place while inserted in the drilled hole. **Do not let nut turn while tightening.**
11. Repeat these steps on the passenger side.

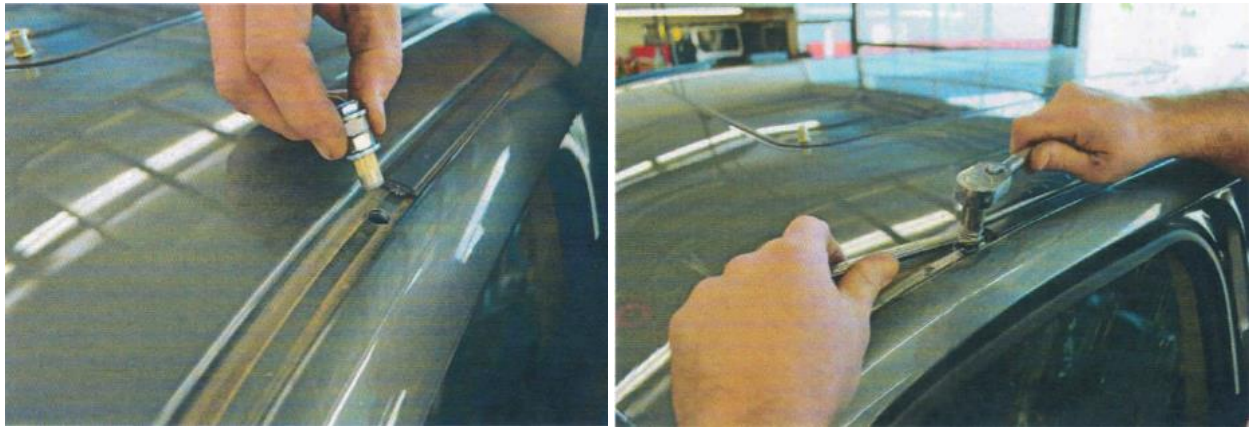

12. Place rubber gasket in where the rubber molding was removed and attach mount to truck using the Allen bolts.
13. Install passenger side bracket on the LED light bar using the light bar's hardware.
14. With a second person, align the passenger side mount with the passenger side holes (predrilled) and install bolts.



15. Attach light bar to the driver side mount and make necessary adjustments and then tighten the bolts holding the light bar to the mounts. **NOTE: Both sides can now be fastened down tightly after mounts are securely attached and aligned.**
16. Route the wire from the light bar down the A-pillar and wire it up according to the light bar's instructions.