



## IMPORTANT WARRANTY & INSTALLATION INSTRUCTIONS ATTACHED

*Please Forward All Attached Information to Consumer. Warranty  
Not Valid Unless Returned to dB Performance Exhaust*

We ask that you take a few moments to  
Complete our warranty registration form.

To Activate Your 10 Year LIMITED WARRANTY, Go To:  
[dBexhaust.com/warranty](http://dBexhaust.com/warranty)



MADE IN THE USA



For Full-Color Installation Instructions, Please Visit:  
[dBexhaust.com](http://dBexhaust.com) & Search Part #

Please be sure to review the enclosed instructions prior to beginning the installation process. If you have any questions about the enclosed parts, instructions or encounter a problem during installation, **CALL dB Performance Exhaust TECHNICAL ASSISTANCE AT 800.486.0999**





dB Performance Exhaust System Installation  
Cat-Back Exhaust System  
Single Side Exit w/ 4" Slash Cut Tip  
2007-08 Chevy Silverado/GMC Sierra 5.3L & 6.0L GMT900  
143.5" WB Ext. Cab Std. Box & Crew Cab Short Box- Part # 24259  
133.5" WB Ext. Cab Short Box- Part # 24267  
119" WB Reg. Cab Std. Box- Part # 24258

**Please take time to read and understand these installation instructions.**

We recommend that the installation of this system be performed by a qualified service center or professional muffler installer who has the necessary equipment, tools and experienced personnel. However, if you decide to perform this install, the use of a hoist and an additional person will be required.

**CAUTION:** Never work on a hot exhaust system. Allow time for the vehicle to cool. Always wear eye protection when working under a vehicle.

**Please confirm that all parts are present before beginning the factory exhaust system removal and dB Performance Exhaust system installation.**

**Recommended Tools:**

- Tape Measure
- Black Marking Pen
- 15mm Socket & Ratchet
- Chain Style Pipe Cutter
- Grommet Pullers
- Soap & Water Solution
- Safety Glasses
- Torque Wrench

**Part #24259**

**Bill of Materials:**

- 1- Headpipe Assembly (16SE4305)
- 2- Muffler Assembly (16SE2024)
- 3- Tailpipe (16SE4307)
- 4- dB Performance Tip (16SE3023)
- 5- Hardware Kit (16TA7205)

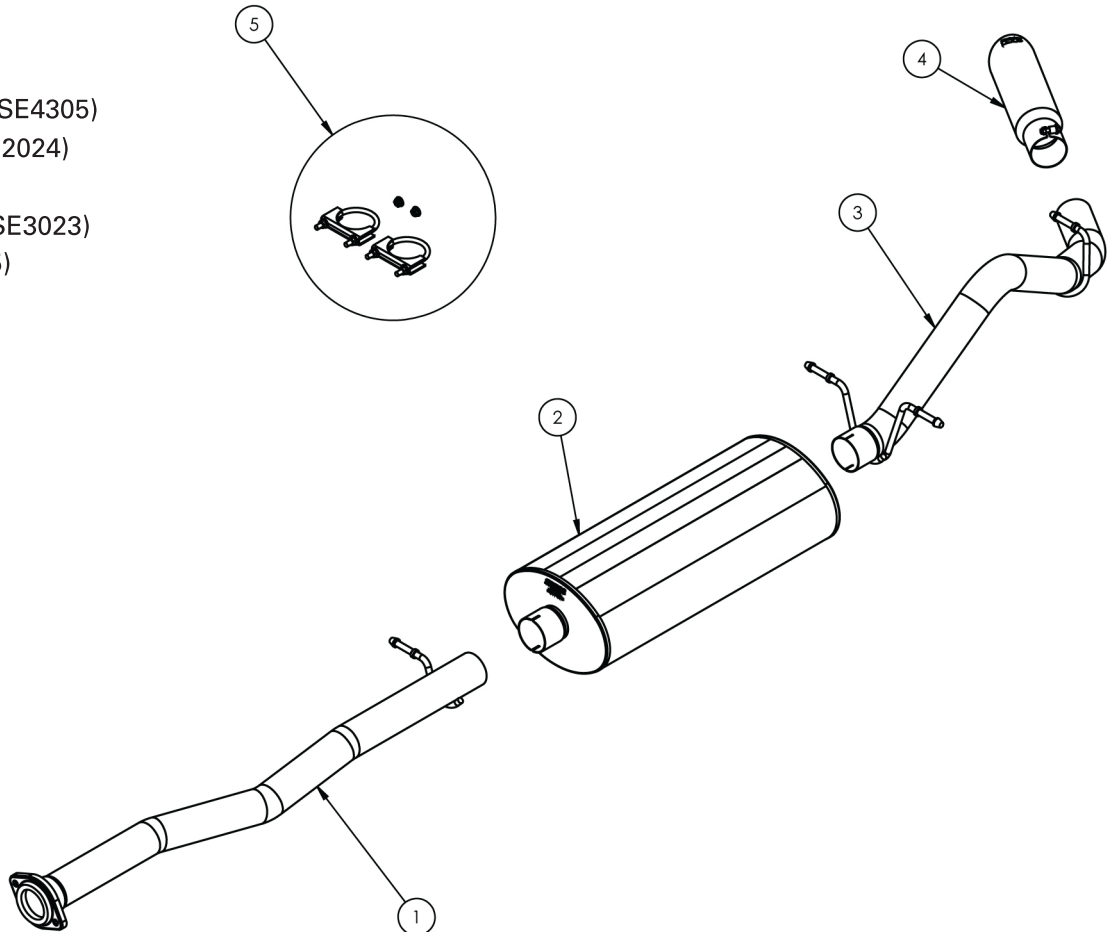



dB Performance Exhaust System Installation  
 Cat-Back Exhaust System  
 Single Side Exit w/ 4" Slash Cut Tip  
 2007-08 Chevy Silverado/GMC Sierra 5.3L & 6.0L GMT900  
 143.5" WB Ext. Cab Std. Box & Crew Cab Short Box- Part # 24259  
 133.5" WB Ext. Cab Short Box- Part # 24267  
 119" WB Reg. Cab Std. Box- Part # 24258

**Part #24267**

**Bill of Materials:**

- 1- Headpipe Assembly (16SE4325)
- 2- Muffler Assembly (16SE2024)
- 3- Tailpipe (16SE4307)
- 4- dB Performance Tip (16SE3023)
- 5- Hardware Kit (16TA7205)

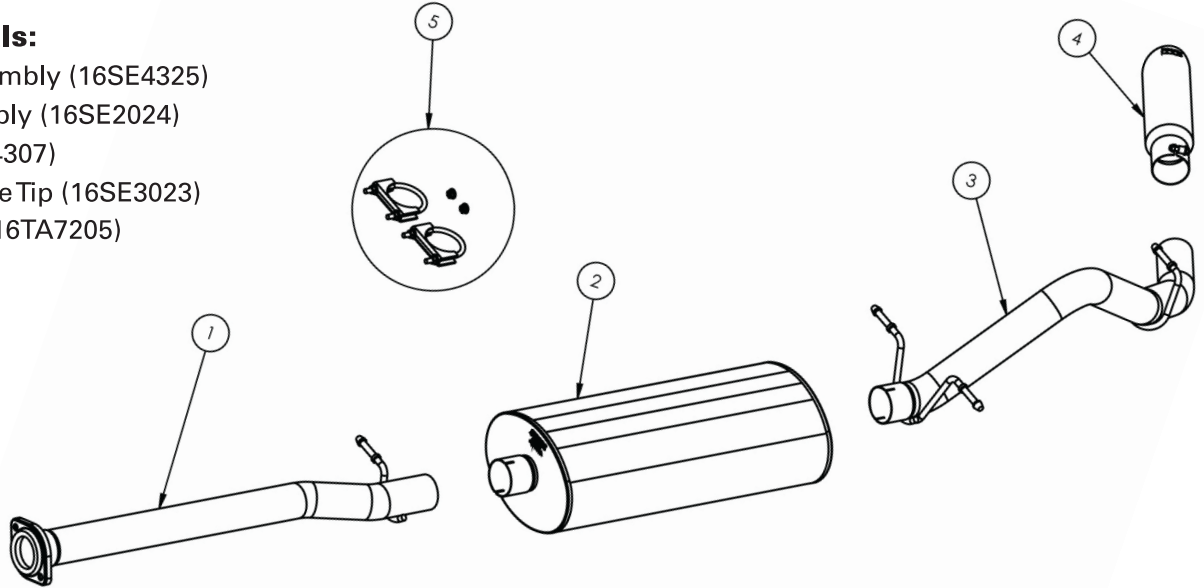

**Part #24258**

**Bill of Materials:**

- 1- Headpipe Assembly (16SE4322)
- 2- Muffler Assembly (16SE2024)
- 3- Tailpipe (16SE4307)
- 4- dB Performance Tip (16SE3023)
- 5- Hardware Kit (16TA7205)

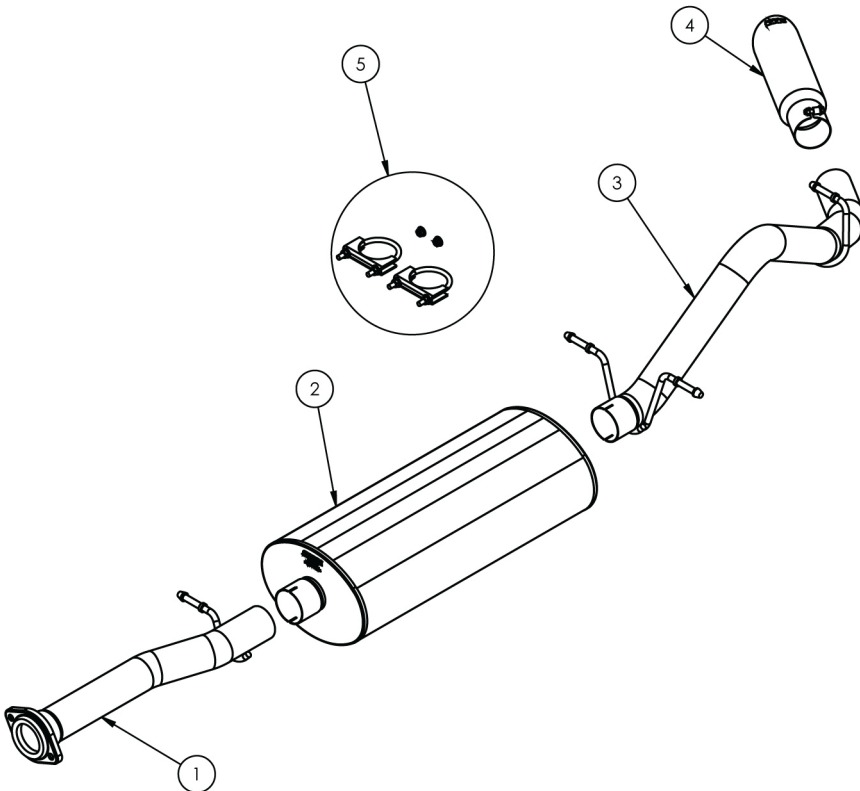

## Stock Exhaust Removal Instructions

### SKIP STEPS 1 & 2 IF INSTALLING ON 119" W.B. REG. CAB/STD. BOX TRUCK.

- 1) Scribe a line 12" from the front face of the stock muffler. (See Fig. A)
- 2) Place a chain style cutter around the exhaust pipe at the scribe line location and cut the exhaust pipe. (See Fig. B)
- 3) Remove the grommets from the tailpipe hangers at the muffler exit, the spare tire and finally ahead of the muffler, using grommet pullers or similar device. (See Fig's C, D & E)  
**Note: Using a soapy solution on the grommet hole will make the job easier.**
- 4) Use a 15mm socket and ratchet to remove the flange nuts at the flange connection of the head-pipe. (See Fig's F & G)
- 5) Remove the muffler and rear tailpipe section from the vehicle by lifting the tailpipe over the rear axle and forwards toward the front of the vehicle. (See Fig's H & I) This completes the removal of the stock system.



FIG. A



FIG. B



FIG. C



FIG. D



FIG. E



FIG. F



FIG. G



FIG. H



FIG. I

**Continue to  
 Page 4  
 for the  
 Installation  
 Process.**

# Installation of dB Performance Exhaust System:

**NOTE:** The supplied double edge clamps in this system will crush and permanently deform the exhaust piping as they are tightened. **DO NOT** tighten these clamps any more than is necessary to lightly hold the exhaust components in place, until the very end of this installation process. It will be difficult or impossible to make any positional or rotational adjustments to the exhaust system after these clamps have been tightened down.

**VERY IMPORTANT:** Align all clamps so that the open edge of the clamp bracket is parallel and aligned with the notch in the pipe, and the outside edge of the clamp bracket is approximately 1/8" from the end of the pipe expansion. (See Fig. 1) Failure to properly position or orient the clamps could result in a weak clamping load, or even a potential leak at the clamp joints.

**IMPORTANT:** Make sure that the small drain holes in the muffler are facing down when the muffler is installed. (See Fig. 2)

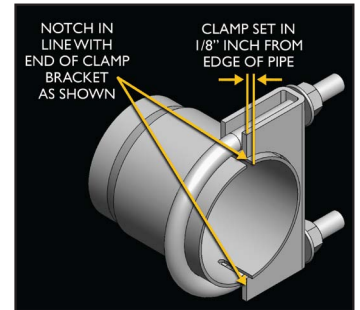

FIG. 1



FIG. 2

- 1) Locate the dB Head Pipe assembly and slide the flange over the studs on the factory flange. Use the nuts supplied with the dB hardware kit and loosely snug. Insert the hanger into the factory grommet. **(See Fig's J, & K)**

**Note:** Using a soapy solution on the grommet hole will make the job easier.



FIG. J

- 2) Make sure the weep hole is facing down, then slide the muffler onto the Head Pipe. Slide a supplied 3" clamp over the inlet of the dB muffler and pre-tighten the clamp. **(See Fig's L, M and N)**



FIG. K



FIG. L



FIG. M



FIG. N

- 3) From the rear of the vehicle slide the pipe over the axle while holding the rear differential vent hose out of the way. Insert the pipe over the muffler exit and place the hangers into the factory grommets. Slide a supplied 3" clamp over the inlet of the dB Tailpipe. Pre-tighten the clamp. **(See Fig's O, P, Q, & R)**  
**Note: Using a soapy solution on the grommet hole will make the job easier.**
- 4) Slide the tip assembly onto the end of the tailpipe. Pre-tighten the clamp at this time. **(See Fig's S, T & U)**
- 5) Adjust all dB components to attain clearance to surrounding parts. Starting from the front of the dB exhaust system tighten all flange nuts to **30 ft-lbs** and all nuts on pipe clamps to **35 ft-lbs** using a torque wrench. Torque the tip clamp to **16-20 ft-lbs**.
- 6) **It is strongly suggested that all clamps be checked and tightened after road testing the vehicle once the system has cooled.**



FIG. O



FIG. P



FIG. Q



FIG. R



FIG. S



FIG. T



FIG. U

**NOTE:** During cold weather start-ups, you may experience an exhaust sound that is deeper and louder in tone than usual. This is temporary and will diminish to normal levels once your engine has reached its normal operating temperature. **NOTE:** Immediately following the installation of your exhaust system, you may experience a trace of smoke after initial start-up. **DO NOT** be alarmed. The smoke is caused by the burning of a small amount of forming oil residue used in the manufacturing process.