

S5210

09-10 FORD F150 4.6L/5.4L, RC 6 1/2" AND
8' BOX, EC/CC, 6 1/2' BOX AND 5 1/2'
BOX, CAT BACK SINGLE SIDE EXIT

MBRP

INC.

PERFORMANCE EXHAUST

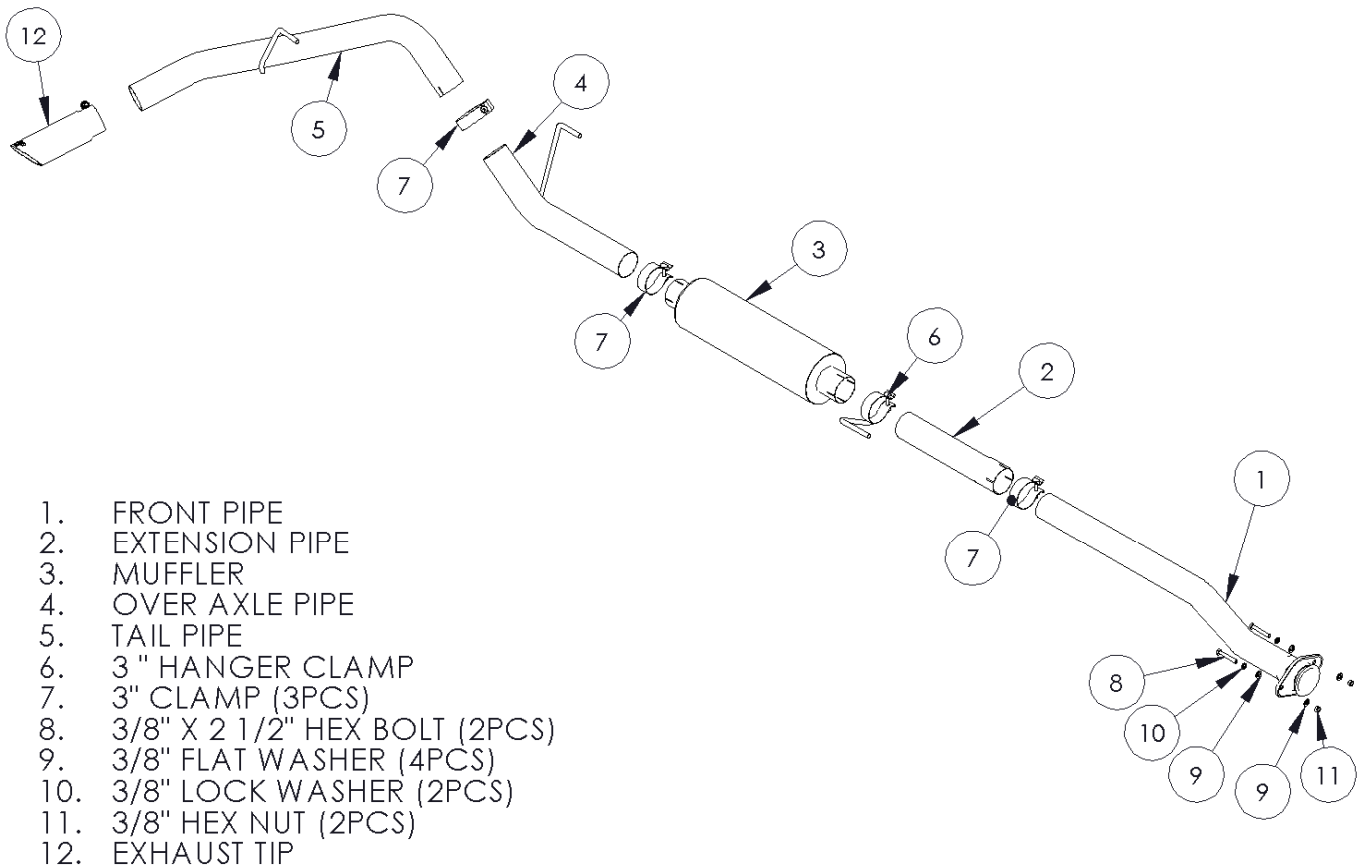

PLEASE READ BEFORE STARTING INSTALATION

While MBRP Inc. has made every effort to ensure that all components of this system are of superior quality and properly packaged, it is the installer's responsibility to ensure the following before removal of the factory exhaust:

- that ALL components shown above are present.
- that ALL mating components fit together.
- that there are no damaged components.
- that the system you have purchased is appropriate for your vehicle year, model and configuration.
- that the system will not interfere with any modifications previously installed or planned.
- that you have read and understand these instructions.

If you have any questions or are uncertain about any aspect of the installation of this system to your vehicle please contact your dealer before commencing installation.

2009 - 2010 FORD F150 4.6L/5.4L

Removal of stock system:

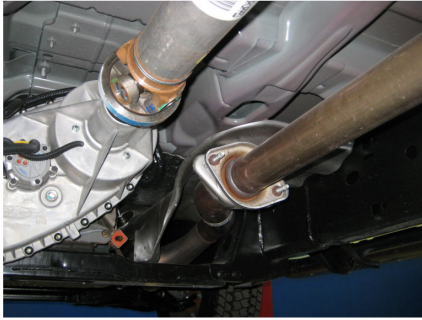

Figure 1

1. Apply a penetrating lubricant liberally to all exhaust fasteners, hangers and rubber insulators.

2. Loosen the flange located behind the “Y” pipe.
Refer to Figure 1.

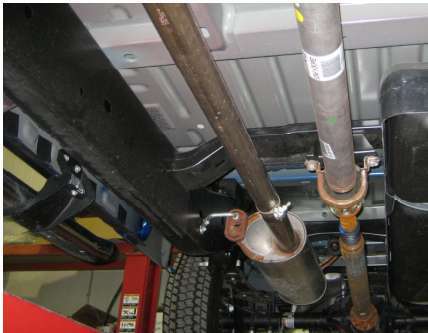

Figure 2

3. Loosen the clamp located in front of the muffler.
Refer to Figure 2.

4. Remove the hangers from the rubber insulators and remove the exhaust from the vehicle. If a hoist or hydraulic lift is not being used the tail pipe may need to be cut to clear the rear axle.
Refer to Figure 3.



Figure 3

Installation of MBRP Inc. Performance Exhaust:

1. Install **Front Pipe** to the existing flange using the fasteners provided.
Refer to Figure 4.

Note; the **Extension Pipe** will not be required on some models.



Figure 4

| Model | Bed Length | Wheelbase | Extension Pipe Required | Shortening Front Pipe Required |
|-------------|------------|-----------|-------------------------|--------------------------------|
| Regular Cab | 6.5' | 145" | No | 19" |
| Regular Cab | 8' | 145" | No | No |
| SuperCab | 6.5' | 145" | No | No |
| SuperCab | 5.5' | 133" | No | 11" |
| SuperCrew | 6.5' | 157" | Yes | No |
| SuperCrew | 5.5' | 145" | No | No |

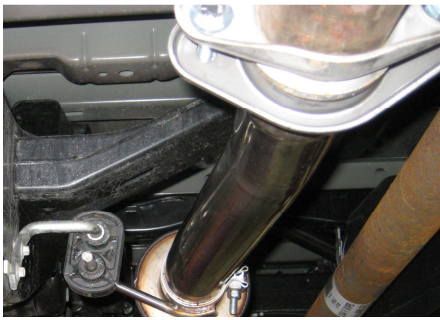

Figure 5

2. Slide a **3" Clamp** over the **Front Pipe** and install **Extension Pipe** onto the **Front Pipe**. Install the **Hanger Clamp** loosely to the **Extension Pipe** (or **Front Pipe** if the **Extension Pipe** is not required) and place the hanger into the existing rubber insulator. **Refer to Figure 5.**



Figure 6

3. Slide the **Muffler** onto the **Extension Pipe** or **Front Pipe** as required. **Refer to Figure 6.**

4. Loosely install the **Over Axle Pipe** connecting it to the **Muffler** outlet using a **3" Clamp**. Install the hanger into the rubber insulator located above the **Over Axle Pipe**. **Refer to Figure 7.**



Figure 7

5. Attach the expanded end of the **Tail Pipe** connect it to the **Over Axle Pipe** using a **3" Clamp**. Slide the **Tail Pipe** hanger into the factory rubber insulator. **Refer to Figure 8.**

8. Install and adjust the **Exhaust Tips** to suit. Using a 17mm wrench tighten the lock bolt on the **Exhaust Tip**. **Refer to Figure 9.**

9. Align the exhaust as required. Starting at the front of the exhaust tighten all clamps and connections.



Figure 8

10. Check along the whole length of the exhaust system to ensure that there is adequate clearance around the spare tire, fuel and brake lines or any wiring. If any interference is detected relocate or adjust.



Figure 9

Congratulations! You are ready to begin experiencing the improved power, sound and driving excitement of your MBRP Inc. performance exhaust system. We know you will enjoy your purchase.