

S5244

2011-2013 FORD F150, 6.2L, SUPER CAB /
CREW CAB, & REG CAB LONG BOX, CAT
BACK, 3 1/2" SINGLE, SIDE EXIT

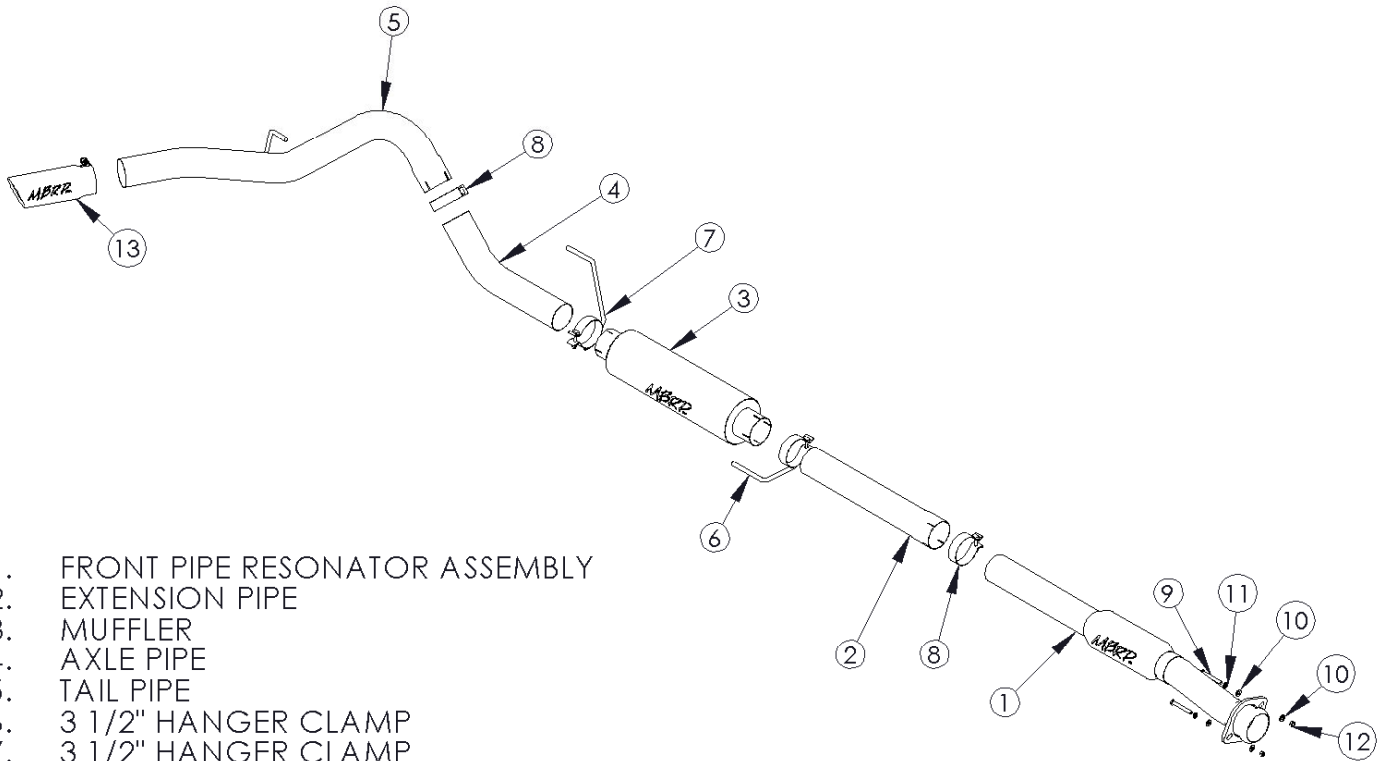

1. FRONT PIPE RESONATOR ASSEMBLY
2. EXTENSION PIPE
3. MUFFLER
4. AXLE PIPE
5. TAIL PIPE
6. 3 1/2" HANGER CLAMP
7. 3 1/2" HANGER CLAMP
8. 3 1/2" CLAMP (2PCS)
9. 3/8" X 3" HEX BOLT (2PCS)
10. 3/8" FLAT WASHER (4PCS)
11. 3/8" LOCK WASHER (2PCS)
12. 3/8" HEX NUT (2PCS)
13. EXHAUST TIP

NOTE: SADDLE CLAMPS ARE USED IN ALUMINIZED SYSTEMS

PLEASE READ BEFORE STARTING INSTALLATION

While MBRP Inc. has made every effort to ensure that all components of this system are of superior quality and properly packaged, it is the installer's responsibility to ensure the following before removal of the factory exhaust:

- that ALL components shown above are present.
- that ALL mating components fit together.
- that there are no damaged components.
- that the system you have purchased is appropriate for your vehicle year, model and configuration.
- that the system will not interfere with any modifications previously installed or planned.
- that you have read and understand these instructions.

If you have any questions or are uncertain about any aspect of the installation of this system to your vehicle please contact your dealer before commencing installation.



Removal of Stock System:



Figure 1



Figure 2



Figure 3



Figure 4

1. Apply a penetrating lubricant liberally to all exhaust fasteners, hangers and rubber insulators.

2. Loosen the flange located behind the “Y” pipe.
Refer to Figure 1.

3. Loosen the clamp located in front of the muffler.
Refer to Figure 2.

4. Remove the hangers from the rubber insulators and remove the exhaust from the vehicle. If a hoist or hydraulic lift is not being used the tail pipe may need to be cut to clear the rear axle.
Refer to Figure 3.

Installation of MBRP Inc. Performance Exhaust:

1. Install the **Front Pipe Resonator Assembly** to the existing flange using the fasteners provided. **Refer to Figure 4.** Some models will require the **Extension Pipe** to be attached to the **Front Pipe Resonator Assembly** using a **3 ½ Clamp**, refer to the table below to see if it is required.

Note: The **Front Pipe Resonator Assembly** or the **Extension Pipe** will require trimming on some models.

Model	Bed Length	Wheelbase	Extension Pipe Required	Shortening Front Pipe or Extension Pipe Required
Regular Cab	8'	145"	No	No
SuperCab	8'	163"	Yes	No
SuperCab	6.5'	145"	No	No
SuperCab	5.5'	133"	No	12"
SuperCrew	6.5'	157"	Yes	6"
SuperCrew	5.5'	145"	No	No



Figure 5

2. Slide the first **3 1/2" Hanger Clamp** over the **Front Pipe Resonator Assembly** or **Extension Pipe** and install the **Muffler** onto the **Front Pipe Resonator Assembly** or **Extension Pipe**. Install the hanger into the existing rubber insulator. **Refer to Figure 5.**



Figure 6

3. Loosely install the **Axle Pipe** connecting it to the **Muffler** outlet using the remaining **3 1/2" Hanger Clamp**. Install the hanger into the rubber insulator located above the **Axle Pipe**. **Refer to Figure 6.**



Figure 7

4. Attach the expanded end of the **Tail Pipe** to the **Axle Pipe** using the remaining **3 1/2" Clamp**. Slide the **Tail Pipe** hanger into the factory rubber insulator. **Refer to Figure 7.**

5. Install and adjust the **Exhaust Tip** to suit. Tighten the lock bolt on the **Exhaust Tip**. **Refer to Figure 7.**

6. Align the exhaust as required. Starting at the front of the exhaust tighten all clamps and connections.

7. Check along the whole length of the exhaust system to ensure that there is adequate clearance around the spare tire, fuel and brake lines or any wiring. If any interference is detected relocate or adjust.



Congratulations! You are ready to begin experiencing the improved power, sound and driving excitement of your MBRP Inc. performance exhaust system. We know you will enjoy your purchase.