



Installation Instructions
For Part Numbers:

400-701 Jr. Kit 850-135 Airaid Oiled Media Filter
401-701 Jr. Kit 851-135 SynthaMax Dry Media Filter - Red
400-901 Modular Intake Tube

2011-2014 Ford F-150
3.5L EcoBoost Turbo V6

Component Identification

AIRRAID PREMIUM FILTER*	1
INTAKE TUBE	1
4" COUPLER	1
3" COUPLER	1
HUMP HOSE	1
#48 HOSE CLAMP	2
#56 HOSE CLAMP	1
#64 HOSE CLAMP	2
#68 HOSE CLAMP	1
BARBED FITTING	1
NPT PLUG	1

* AIRRAID PREMIUM FILTER included only in JR. kit.

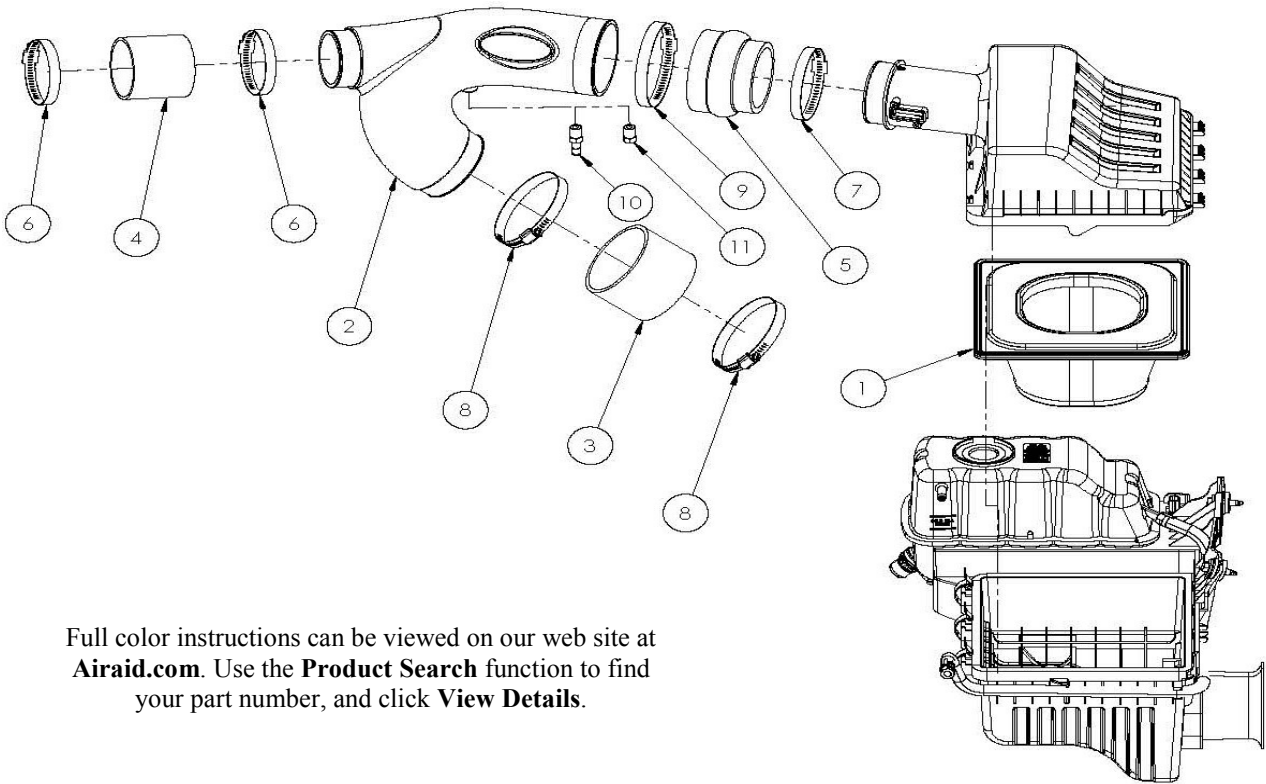

Full color instructions can be viewed on our web site at Airaid.com. Use the **Product Search** function to find your part number, and click **View Details**.

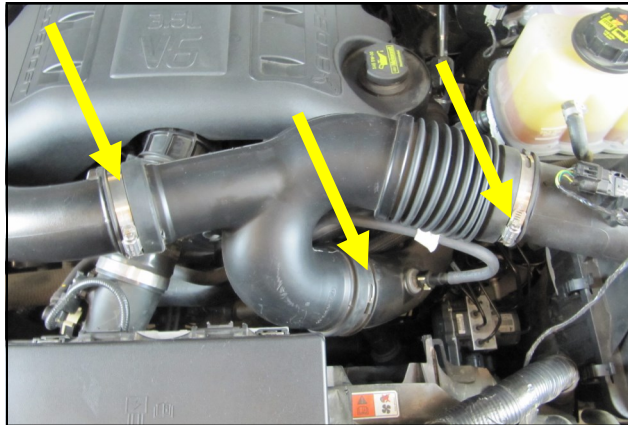

1. Disconnect The Negative Battery Terminal.
Loosen the 3 clamps on the factory intake tube and remove it from the vehicle.
NOTE: 2011 models will have a vacuum line attached to the underside of the intake tube that will need to be disconnected.

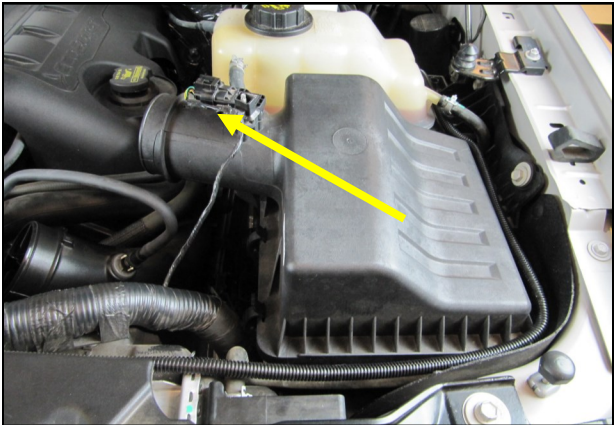

2. Disconnect the wiring harness from air sensor in the air box lid. Unclip the air box lid and remove it and the factory air filter from the vehicle. The lower half of the factory air box is to remain in the vehicle.

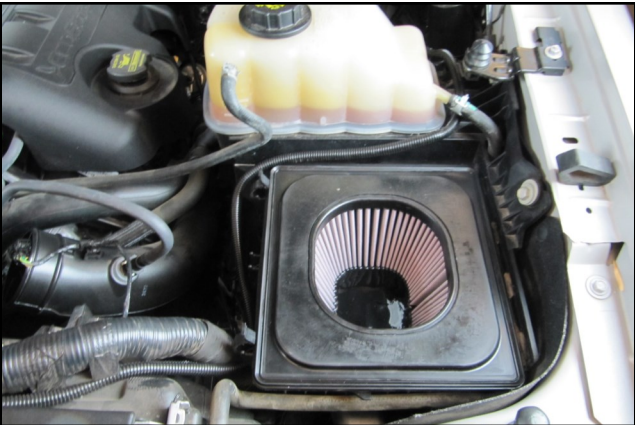

3. If installing an Airaid Jr. kit, replace the factory air filter with the Airaid Premium Filter at this time.

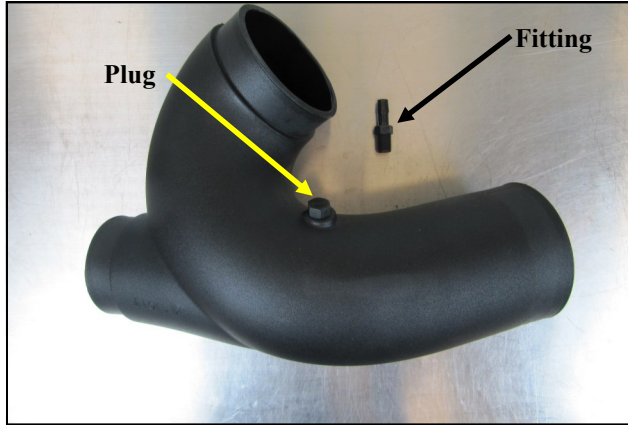

4. On late model vehicles, Install the 1/4" Plug into the Airaid Intake Tube as shown.
On 2011 models with the vacuum line in the intake, install the 1/4" Barbed Fitting. The Plug will not be used.

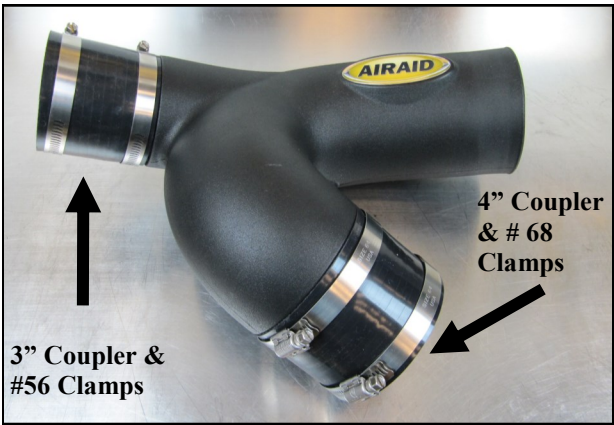

5. Slide the Couplers and Clamps onto the Intake tube as shown.



6. Install the Airaid Intake Tube onto the factory turbo plumbing and tighten the Clamps. Reconnect the vacuum line if so equipped

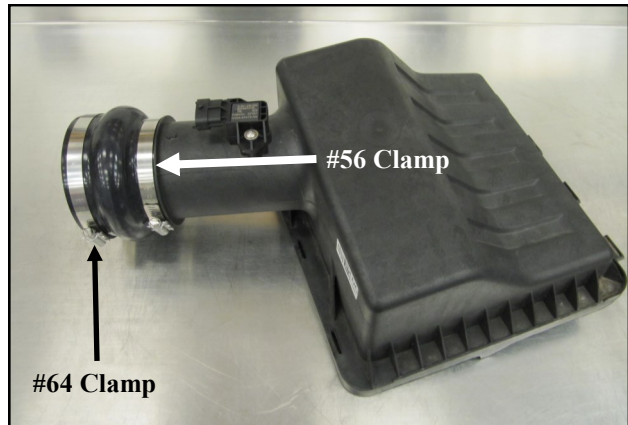

7. Slide the Hump Hose and the two remaining Clamps onto the OEM air box lid as shown.

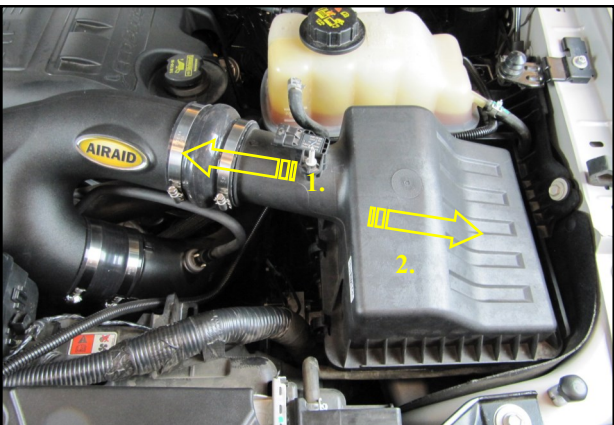

8. Slide the Hump Hose onto the Airaid Intake tube as far as it will go then insert the air box lid tabs into the slots. Adjust the assembly until the lower air box clips can positively engage the lid and lock.

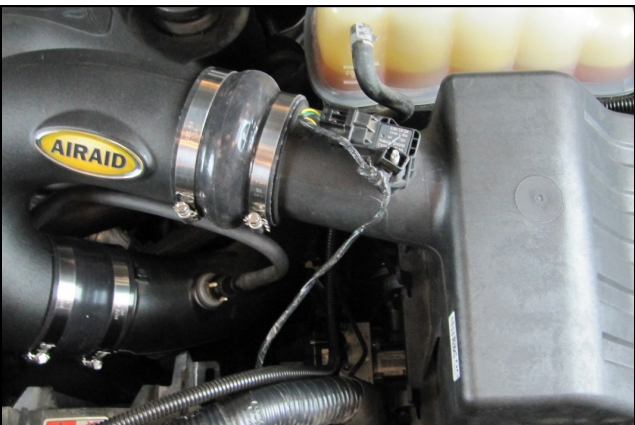

9. Reconnect the air meter or Map sensor and tighten all Clamps.



10. Double check your work.

Make sure there is no foreign material in the intake path. Make sure all clamps, hoses, bolts, and screws are tight. Double check the hood clearance.

Reconnect the negative battery cable.

Thank you for purchasing the Airaid Intake System. Contact Airaid @ (800) 498-6951 8:00 AM - 5:00 PM MST week-days for questions regarding fit or instructions that are not clear to you. Your Airaid Intake System was carefully inspected and packaged. Check that no parts are missing, or were damaged during shipping. If any parts are missing, contact Airaid. The air filter element is protected from direct exposure to water and debris; care should be taken not to drive through deep water. WATER INGESTION IS THE DRIVERS RESPONSIBILITY! The air filter is reusable and should be cleaned periodically.

FILTER IDENTIFICATION

860-397 Airaid Oiled Media
862-397 Airaid SynthaMax Dry Media - Black

861-397 Airaid SynthaMax Dry Media - Red
863-397 Airaid SynthaMax Dry Media - Blue

For your Oiled media filter
we suggest using the AIRAID
Filter Tune-Up Kit!



Do Not Oil

Synthamax Air Filters do not require oil. Service air filter as needed by cleaning with common non-petroleum all-purpose household cleaner and water. Simple Green®, Formula 409® or equivalent works great. Apply cleaner to outside of air filter and allow to soak. Then flush filter clean from the inside out with a garden hose and repeat steps if necessary. Do not apply high pressure water or air to clean filter. Allow filter to air dry and reinstall.



P/N 790-551 Aerosol Spray
P/N 790-550 Squeeze Spray