



AUTOMOTIVE PRODUCTS,

INSTALLATION INSTRUCTIONS

PRODUCT DESCRIPTION

APPLICATION: 2009-2014 FORD F-150

PART NUMBER: 32-31030, 32-31035, 32-31035T

CONTOUR 3.5" BULL BAR

CONTENT			
ITEM	QUANTITY	DESCRIPTION	TOOLS NEEDED
1	1	CONTOUR BULL BAR	18MM SOCKET
2	1	DRIVER SIDE MOUNTING BRACKET	RATCHET
3	1	PASSENGER SIDE MOUNTING BRACKET	TORQUE WRENCH
4	1	DRIVER SIDE UPPER SUPPORT STRAP	UTILITY KNIFE
5	1	PASSENGER SIDE UPPER SUPPORT STRAP	18MM WRENCH
6	4	M10 Flat Washer, Small (YELLOW ZINC)	16MM SOCKET
7	4	M10 Split Lock Washer (YELLOW ZINC)	16MM WRENCH
8	2	M10 Hex Nut (YELLOW ZINC)	
9	2	M10-1.5X140 Hex Head Cap Screw, Class 8.8 (YELLOW ZINC)	
10	2	M10 Flat Washer, Large (YELLOW ZINC)	
11	2	M10-1.50 Clip Nut (YELLOW ZINC)	
12	2	M10-1.50 x 30mm Hex Head Cap Screw, Class 8.8 (YELLOW ZINC)	
13	2	M12 Split Lock Washer (YELLOW ZINC)	
14	2	M12 Flat Washer, Large (YELLOW ZINC)	
15	2	M12-1.75 x 35mm Hex Head Cap Screw (STAINLESS STEEL)	
16	2	M12 Flat Washer, Small (STAINLESS STEEL)	
17	8	M10 Flat Washer, Medium (STAINLESS STEEL)	
18	4	M10-1.50 Hex Nuts (STAINLESS STEEL)	
19	6	M10-1.50x35 Hex Head Cap Screw (STAINLESS STEEL)	
20	6	M10 Split Lock Washer (STAINLESS STEEL)	
21	2	M10 Flat Washer, Small (STAINLESS STEEL)	
22	2	M12 Hex Nut (YELLOW ZINC)	

ANTI-SEIZE LUBRICANT MUST BE USED ON ALL STAINLESS STEEL FASTENERS TO PREVENT THREAD DAMAGE AND GALLING

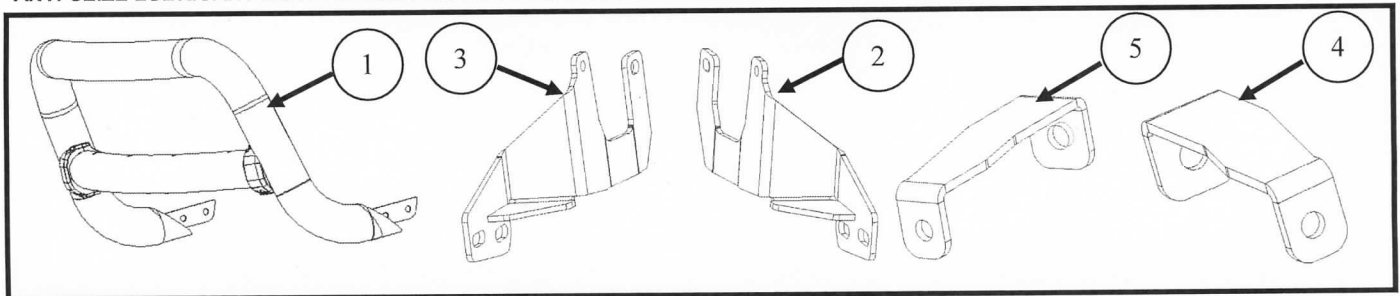

Westin Automotive Products, Inc.
320 W. Covina Blvd
San Dimas, Ca. 91773

P.N.: 75-3098-RevA

ECO #: W14-0121

1

Thank You for choosing Westin products
For Additional installation assistance please call
Customer service (800) 793-7846
www.westinautomotive.com

DATE: 06/18/15

Bull Bar hardware assembly

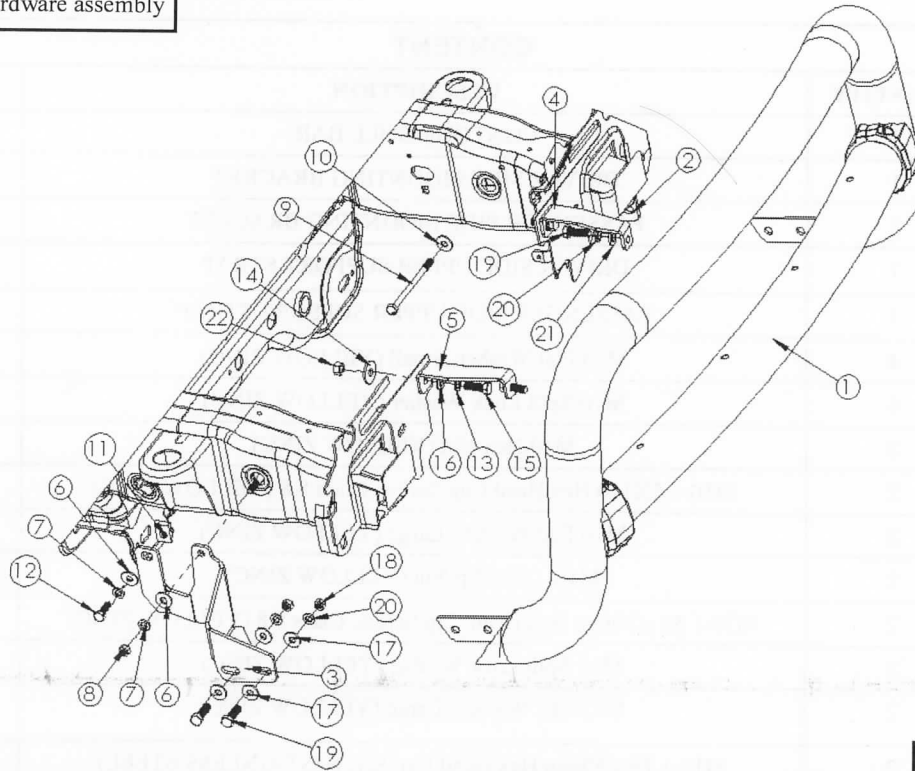

Fig. 6



Westin Automotive Products, Inc.
320 W. Covina Blvd
San Dimas, Ca. 91773

Thank You for choosing Westin products
For Additional installation assistance please call
Customer service (800) 793-7846
www.westinautomotive.com

PROCEDURE

1. Remove contents from box, verify if all parts listed are present and free from damage. Carefully read and understand all instructions before attempting installation. **Failure to identify damage before installation could lead to a rejection of any claim.**
2. Start installation on the driver side from under the front of the vehicle. **NOTE:** Trimming of the front valance is required in order to install the lower mounting brackets. From outer flange to outer flange, the lower brackets should measure 45"-1/4". The approximate dimensions for the cut outs are shown in **Figure 1.** (**NOTE:** Trim as necessary)

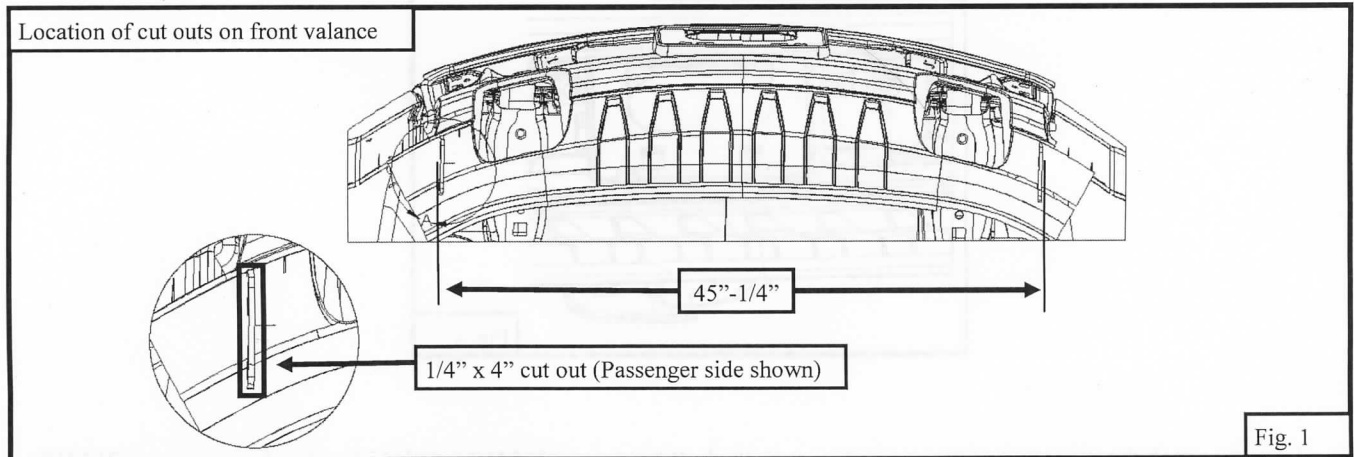

3. Clip the supplied M10 clip nut to the slot right above the square hole in the vehicles frame channel. Make sure that the threaded hole is concentric with the square hole below the slot. Refer to **Figure 2.**
4. Locate the lower mounting bracket and place it up against the frame channel, making sure to align the two holes of the bracket with the side holes in the frame channel. Loosely secure the rear bracket hole to the clip nut using (1) M10-1.50X30MM hex head cap screw, (1)M10 split lock washer, (1)M10 small flat washer. Secure the bracket's front hole using (1) M10-1.50X140MM hex head cap screw, (1) M10 small flat washer, (1) M10 split lock washer, and (1) M10 hex nut. Refer to **Figure 3.**

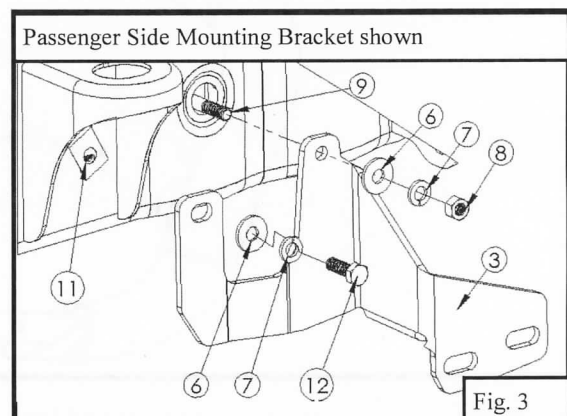
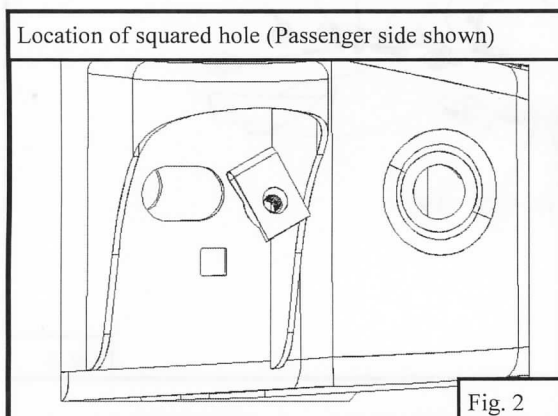

5. Loosely secure one end of the upper support strap to the vehicle using the supplied M12 hardware. Refer to **Figure 4**.
6. Repeat steps 3-5 for passenger side.
7. With assistance, hold the bull bar up in position on the outside of the lower mounting brackets. Loosely attach the bull bar to the brackets using (4) M10-1.50X35 hex head cap screws, (8) M10 medium flat washer, (4) M10 split lock washers, and (4) M10 hex nuts. Refer to **Figure 6** for a picture showing the mounting hardware.

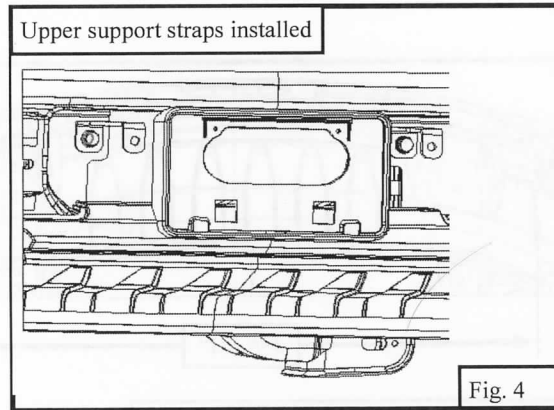

8. Loosely attach the other end of the support strap to the bull bar using (2) M10-1.50X35 hex head cap screws, (2) M10 split lock washers, and (2) M10 small flat washers. Refer to **Figure 5**.
9. Align and adjust the bull bar as necessary. Tighten and torque all M10 hardware to 25 ft-lbs and M12 hardware to 55 ft-lbs.

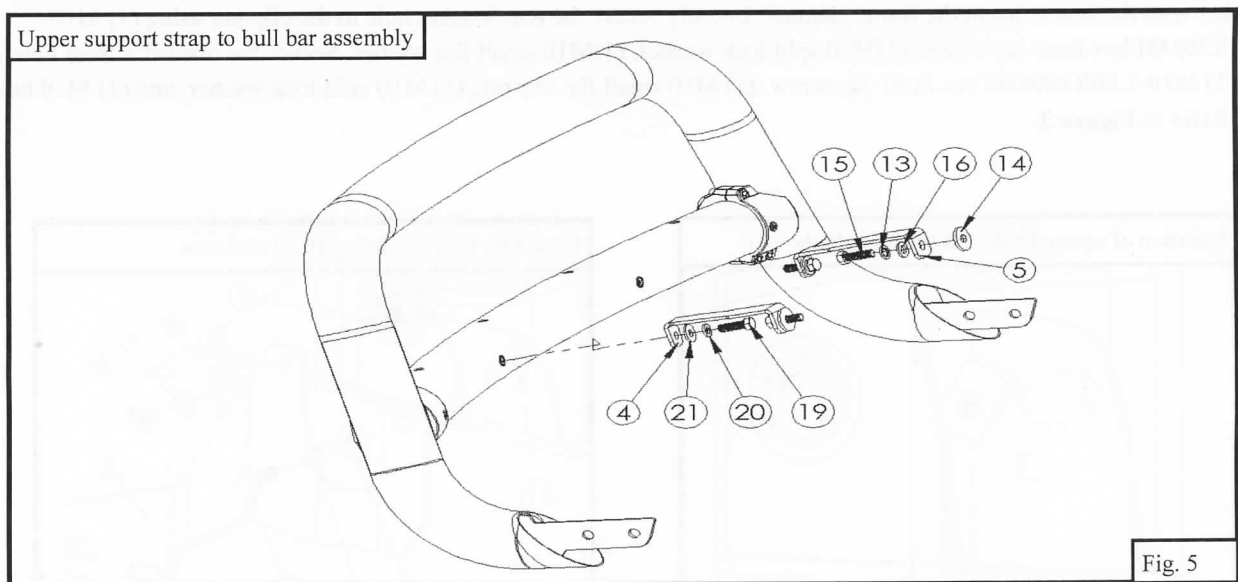

INSTALLATION COMPLETE



CARE INSTRUCTIONS

- REGULAR WAXING IS RECOMMENDED. DO NOT USE ANY TYPE OF POLISH OR WAX THAT MAY CONTAIN ABRASIVES.
- STAINLESS STEEL PRODUCTS CAN BE CLEANED WITH MILD SOAP AND WATER. STAINLESS STEEL POLISH SHOULD BE USED TO POLISH SMALL SCRATCHES.
- GLOSS BLACK FINISHES SHOULD BE CLEANED WITH MILD SOAP AND WATER.



Westin Automotive Products, Inc.
320 W. Covina Blvd
San Dimas, Ca. 91773

Thank You for choosing Westin products
For Additional installation assistance please call
Customer service (800) 793-7846
www.westinautomotive.com