

INSTRUCTIONS

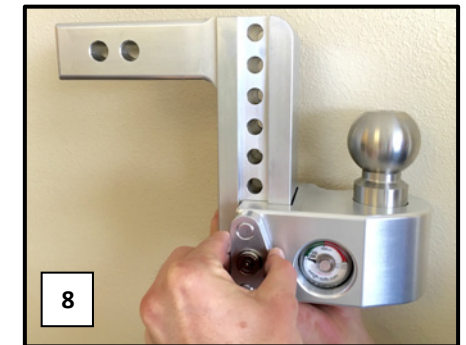
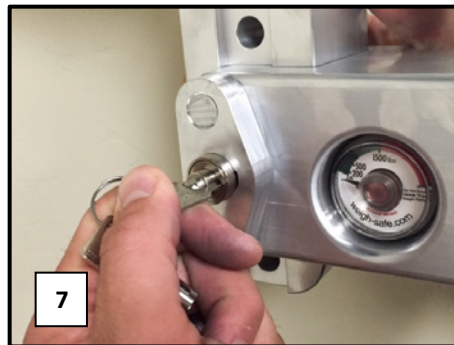
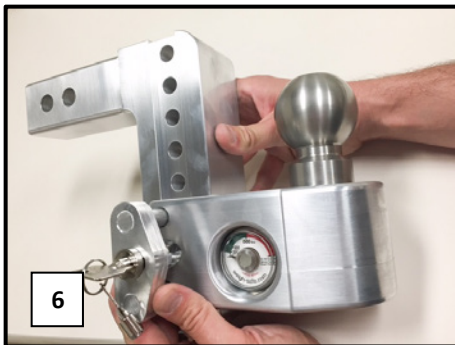
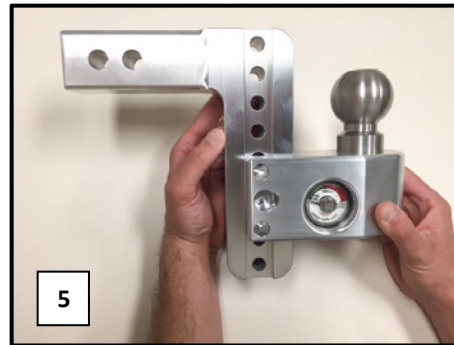
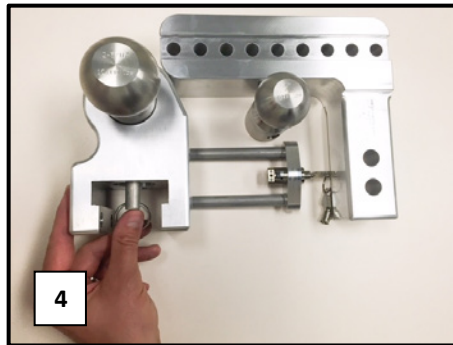
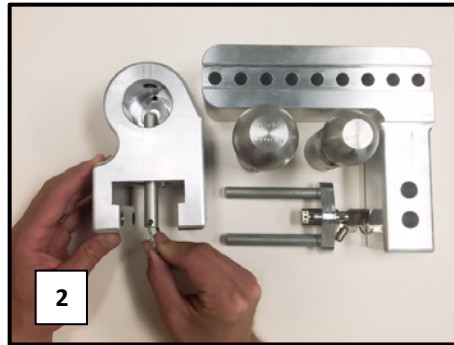
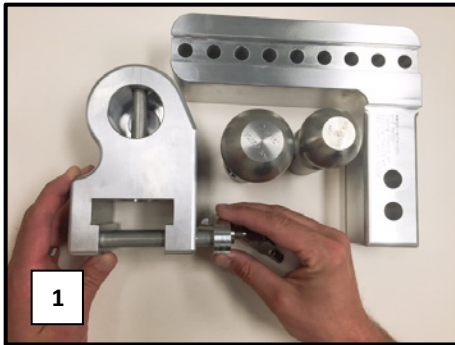

1. Insert key and remove [ball mount](#) lock pins.
2. Remove ball-retaining pin.
3. Insert desired ball size.
4. Replace ball-retaining pin. **DO NOT OPERATE WITHOUT BALL PIN IN PLACE.**
5. Slide ball mount on drawbar to desired drop height. Hitch may also be used in rise position.
6. Replace ball mount lock pins.
7. Lock in place and remove key.
8. **DO NOT OPERATE WITHOUT CHECKING TO MAKE SURE THE LOCK IS SECURELY IN PLACE.** Do this by removing the key and pulling on the lock plate.
9. Secure your Weigh Safe hitch to standard 2" or 2.5" receiver with locking pin.
10. Ensure safety chains are attached appropriately between vehicle and trailer. DO NOT attach safety chains directly to hitch.
11. Tongue weight should be between 10-15 percent of gross trailer weight (GTW). Weigh Safe max tongue weight is 1500 lbs (2" Shank) and 2200 lbs (2.5" shank). DO NOT initiate tow if scale reading is beyond the MAX tongue weight.
12. **Never exceed the LOWER rating between:**
 - (A) Towing vehicle manufacturer's load **OR** (B) Weigh Safe GTW hitch ratings (below)
 - 7500 lbs (1-7/8" ball), 8000 lbs (2" ball),
10,000 lbs (2-5/16" ball & 2" shank), 14,500 lbs (2-5/16" ball & 2.5" shank)