



advanced FLOW engineering™
 P.O. Box 1719
 Corona, CA 92879
 Support: 951-493-7100
 www.aFepower.com

Intake kit Installation Instructions: 2007.5 Ford F-150 V8-4.6L Stage 2 Cx

Kit P/N: 51-11402 / 54-11402	Tools Required: 11mm socket or wrench 10mm socket or wrench 5/16" nut driver 1/4" nut driver Flat head screwdriver Ratchet w/ extension T-20 torx bit (included)	Parts list: 1 Air filter (P/N 24-90039 or Pro Dry S™ 21-90039) 1 Housing, wrinkle black 1 Tube 1 Adapter, MAF 1 Gasket, MAF adapter 1 Coupler, straight 3-1/4" x 2"L 1 Coupler, hump 3-1/2" x 3"L 1 3/4" trim seal @ 18.5"L 1 5/8" hose @ 21"L 2 Clamp, #060 2 Clamp, #052 2 Clamp, mini #008	1 Gasket, MAF sensor 2 Spacer, nylon 1/2" x 1/4" x 1/8" 2 Screws, hex M4 x .7 x16 4 Screws, hex M6 x 1 x 20 4 Washers, wavy M6 1 Washer, flat 1 Screw, hex M6 x 1 x 12 2 Spacer, plastic black 2 Screw, hex 1/4"-20 x 1.25 2 Locknut, hex 1/4"-20 2 Washer, fender 1/4" x 7/8"OD 1 Torx bit, T-20 1 Adapter, injection molded 6"
-------------------------------------	--	--	--



Step 1
Complete Stock Intake.



Step 2
With 5/16" nut driver loosen clamp at throttle body. Disconnect and remove OE crank case line.



Step 3
Loosen the clamp at air box side and remove OE intake tube.

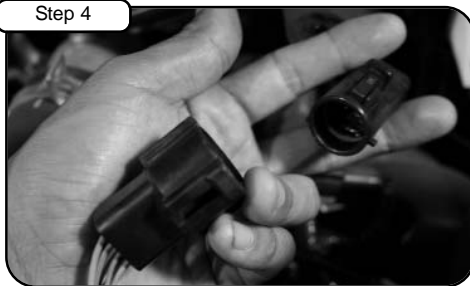

Step 4
Disconnect bottom MAF sensor harness under air box bracket.

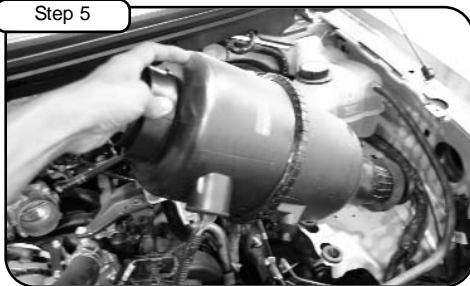

Step 5
Lift up and remove OE air box out of vehicle.



Step 6
Disconnect band clamp and with flat head screwdriver, disconnect other end of MAF harness. Carefully pull out OE MAF sensor tube.

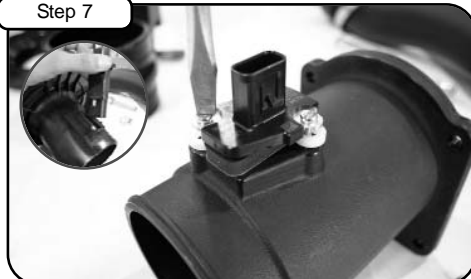

Step 7
With T-20 torx bit remove MAF sensor and (with gasket, nylon spacers and screws provided) install into new tube. Make sure gasket and nylon spacers are between sensor and tube.

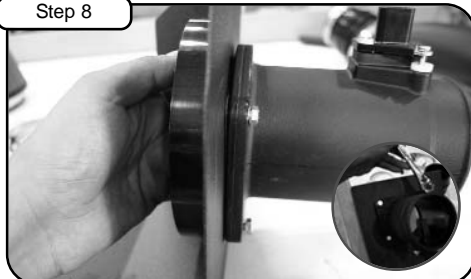

Step 8
Install 6" adapter inside of housing. With gasket provided between outside of housing and MAF tube adapter install hex screws w/ wavy washers provided. Tighten using 10mm socket or wrench.

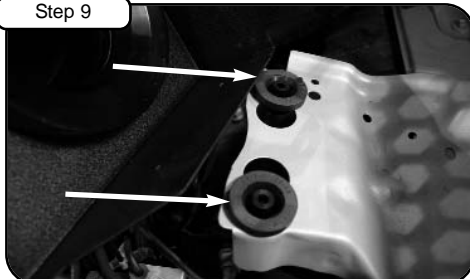

Step 9
With black plastic spacer, place inside of OE air box grommets. Install housing with 1/4"-20 screw, nut and washers provided.



Step 10
Place 5/8" hose to new tube with mini clamp provided and tighten using 1/4" nut driver. Install couplers with clamps provided to new tube.



Step 11
Install new tube to throttle body and intake housing. Tighten clamps with 5/16" nut driver. Finish install on crank case line with mini clamp and tighten.



Step 12
Tighten housing using 11mm socket or wrench. Install 3/4" trim seal to housing.



Step 13
Reconnect both ends of MAF sensor harness.

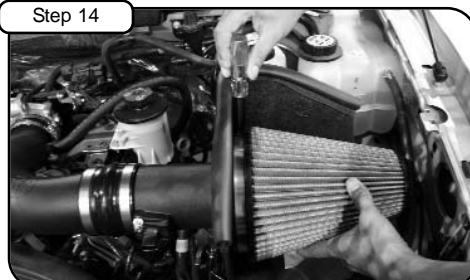

Step 14
Install air filter and tighten using 5/16" nut driver.



Step 15
Your installation is now complete. Please check all bolts and clamps periodically. Re-tighten if necessary. Thank you for choosing aFe!

Note: Filter Cleaning and Re-oiling: When cleaning your aFe filter, be sure to use only aFe's "Restore Kit" (aFe P/N: 90-50001 blue oil aerosol, or aFe P/N: 90-50501 blue squeeze bottle oil)
 Filter Replacement: Magnum FLOW PN: 24-90039 (black w/blue media) or Pro Dry S™ P/N 21-90039 (black w/white media) Pro Dry S™ cleaning: see cleaning instruction sheet 06-00074