

Step 1: Open factory fuel door. Unlock tab on existing fuel door and slide the old door out.

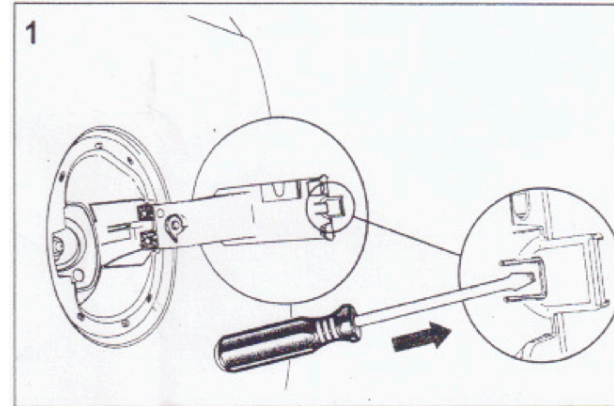

Step 2: Notice the ridges (teeth) in the replacement fuel door as well as the rectangular fuel door bracket. Align the fuel door and rectangular bracket so that the ridges fit into place. Snap the door down and slide it over so that it locks into place.

Step 3: Close the door and enjoy your brand new DefenderWorx fuel door!

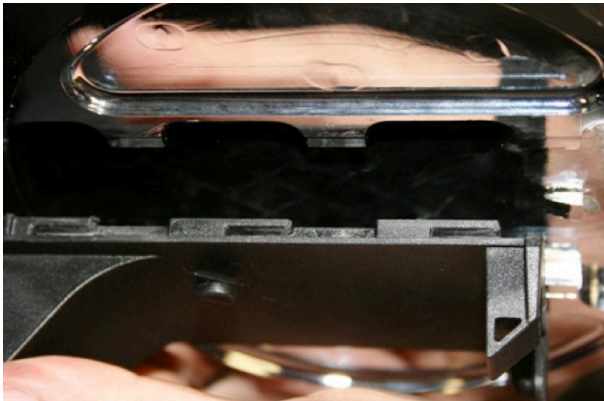