

OWNER'S MANUAL

Titanium



HARD ROLL-UP TONNEAU COVER

Phone: (1-877-878-9336) Fax: (605) 664-9304

P/N 1117941 Rev P4

THREE YEAR WARRANTY

TruXedo, Inc. warrants that all new, unused products are free from defects in material and workmanship. This Three Year Limited Warranty is effective if the product is properly installed and used for the purpose intended. It applies to the original buyer only. TruXedo's obligation under this Warranty is limited to repairing, or at its option, replacing any part that is returned, transportation prepaid, to TruXedo, Inc., Yankton, South Dakota, if the product is, in our judgment, defective. All materials must be accompanied by an RMA (Returned Material Authorization) number requested by and authorized in advance of returning the materials. TruXedo, Inc. shall not be liable or responsible to supply or pay labor to replace any part found defective, nor shall it be liable for any damages of any kind or nature to person, product, or property.

There are no Warranties for used products or products that have been repaired, altered, modified, subjected to misuse, negligence, accident or ordinary wear and tear. Warranty registration must be on file and/or proof of original purchase (detailed and dated receipt) required for warranty to be valid. For warranty registration, see form below. Call 1-877-878-9336 for complete details.

DIRECT ALL WARRANTY CLAIMS TO TRUXEDO AT 1-877-878-9336

SAFETY INSTRUCTIONS

1. Do not place objects on or against cover or framework.
2. Do not tie cargo to tonneau cover framework.
3. **Never** allow children or pets to occupy pickup box while cover is closed.
4. Cover is not airtight. Special care is required to keep cargo clean and dry.
5. Fabric cover won't prevent theft of contents inside truck box.
6. Cover must be rolled fully open and secured with safety straps when towing vehicle backwards.
7. **DO NOT stow rolled cover against cab window.**
8. **DO NOT ATTEMPT TO DRIVE WITH THE COVER IN THE PARTIALLY OPEN POSITION!**
9. **A FULLY ROLLED OPEN COVER MUST ALWAYS BE SECURED WITH SAFETY RETAINER STRAPS.**
10. **DO NOT operate vehicle with objects on top of the cover.**

OWNER/USER RESPONSIBILITIES

It is the responsibility of the owner/user to read this manual and comply with the operating procedures. The owner/user is also responsible for inspecting the TruXedo® cover, and for having parts repaired or replaced when worn or damaged.

Failure to follow safety instructions and warning labels could result in failure of your cover system and/or personal injury.

MESSAGES TO INSTALLER

- Always wear safety glasses and/or other necessary protective equipment when installing your TruXedo®.
- These instructions are complete for most pickup models. Additional instructions are included, if required for your truck. Please read entire manual before installing your TruXedo®.

IMPORTANT OPERATING TIPS

- Tonneau cover must be free of foreign material including snow and ice before rolling cover open or closed.
- It is recommended to operate vehicle with cover rolled closed and latched for optimal fuel economy.
- Prolong cold weather will make cover fabric stiff. Move vehicle with cover unrolled and latched into sun or indoors to warm the top surface.
- If cover has been stored in a rolled up state for a long period of time it may take few minutes for the cover to lay flat. The fabric material needs to relax to a flat state, this is normal.
- **DO NOT** roll cover into rear cab window. **DO NOT** Stow against Cab.

COVER CARE AND MAINTENANCE

1. Vinyl cover can be hand washed with mild soap and water or cleaned in a car wash. Thoroughly rinse cover to remove any soap residue. Cover can be treated with any vinyl protectant made for tonneau covers. **Never use silicon, petroleum, or citrus based products on your tonneau cover fabric.**
2. It is recommended that you periodically check that the cover is securely attached to your truck bed. Inspect the clamps and front header guide slides to ensure they were properly installed and have not come loose during operation.
3. It is recommended that you periodically inspect and service the rear latch closures. Clean away any excess dirt or grime and lubricate with silicone spray. Ensure the latches move freely in and out to properly engage the side rail and provide performance with optimal security. Be careful not to overspray the cover. Wipe away any excess silicone around the latch location.

Components

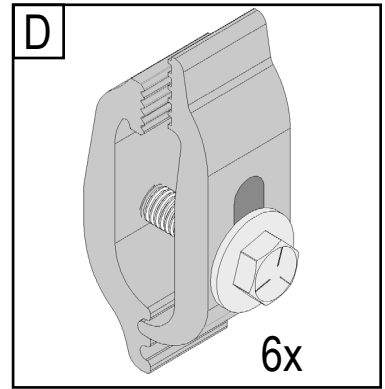
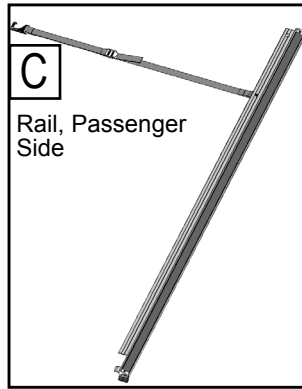
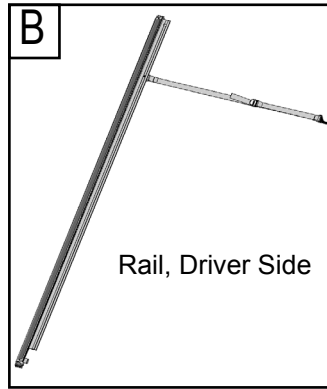
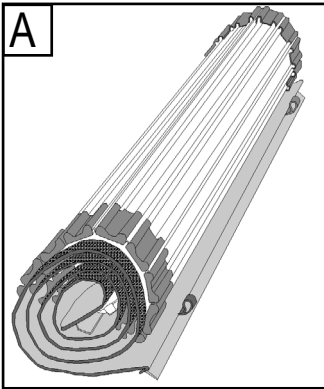

Tools Required

1/2"

Correct

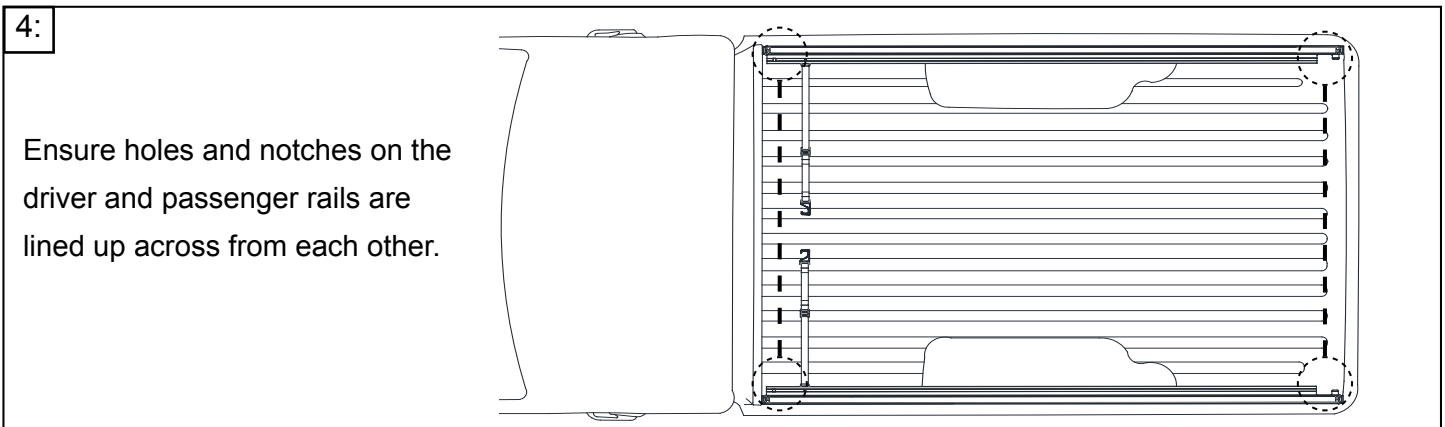
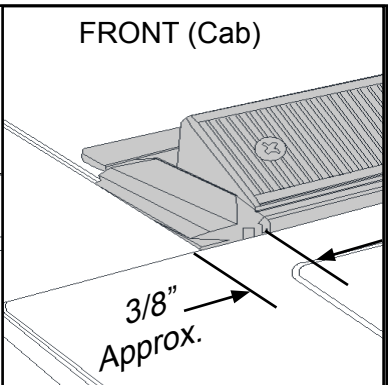
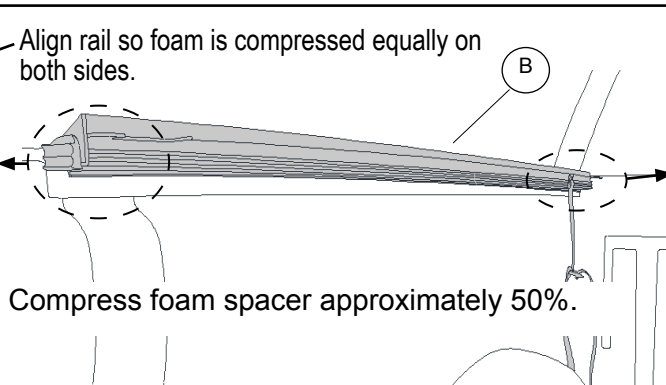
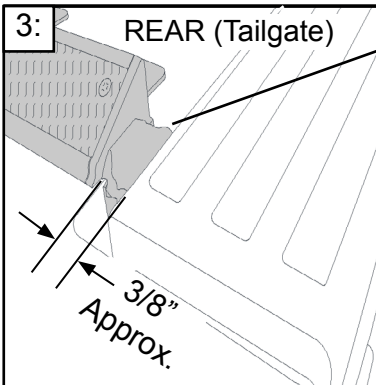
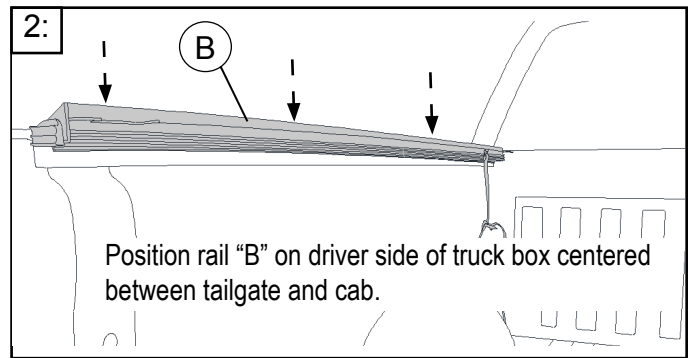
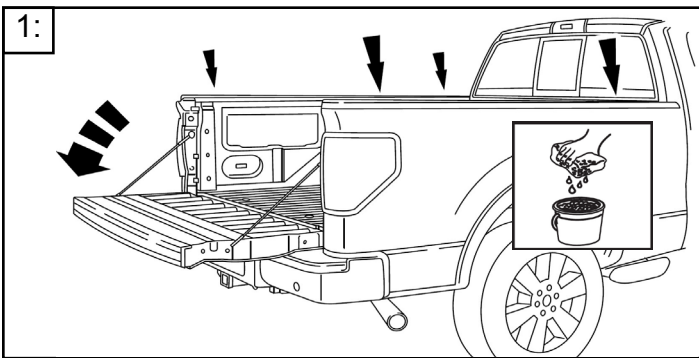
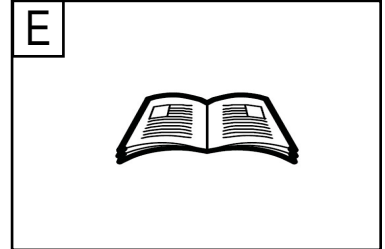

5:

LEVEL
ADJUSTABLE CLAMP

WARNING
Tighten clamps securely on side rails before driving vehicle.
It is recommended that rails be mounted level. Position clamps high to start and reposition lower, as needed, to achieve rails that are mounted level.

6: Repeat steps 2-4 on passenger side for item C. When finished proceed to step 7.

7:

8:

Secure rolled cover to side rails.
Slide header guides under the rail until CLICK is sounded.

LEFT **RIGHT**

9: Unroll cover to the tailgate.

CAUTION
PINCH POINTS
CAN CAUSE SERIOUS
PERSONAL INJURY

Cable latch Release

10: Latch Both Sides.

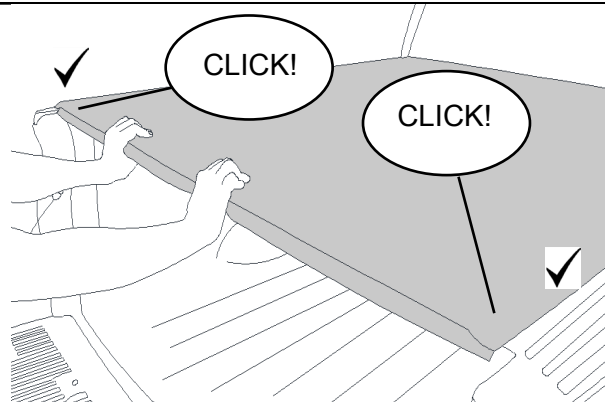
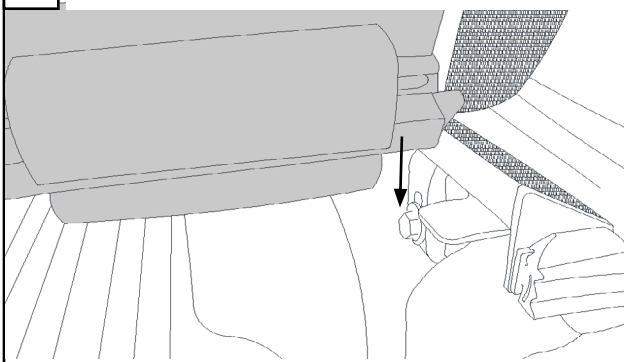

11: PREFERRED METHOD OF CLOSURE: Close and latch cover then close tailgate with the seal to the inside of the tailgate.

ALTERNATIVE METHOD OF CLOSING COVER: Close tailgate, then close cover on top of tailgate. This method will not work with some truck applications. Use preferred method instead.

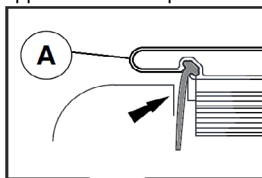

NOTE: If you have a key lock tailgate, tonneau cover is secured until tailgate is unlocked and opened.

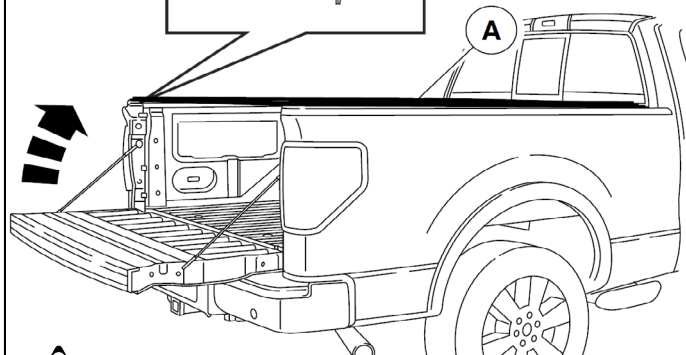

Make sure cover is securely latched on both sides before operating vehicle.

12: Secure Hook and Loop down both sides along entire length of cover system.

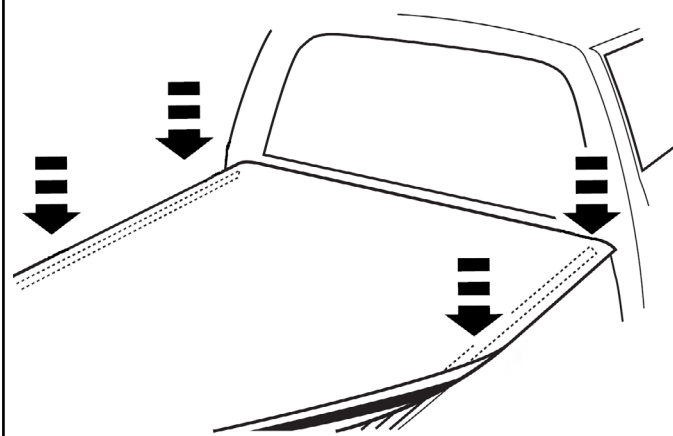

NOTE: Secure hook fastener and loop fastener along entire length of both side rails before driving vehicle. This will prevent wind lifting the cover and causing damage.

ATTENTION!

FOR BEST RESULTS after the initial installation leave cover closed and latched for a 24 hour period. This will insure that the fabric has taken a complete set to the metal substrate.

13: To Open Cover, Pull Down On Release Cable

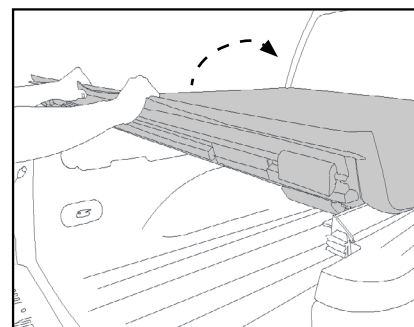
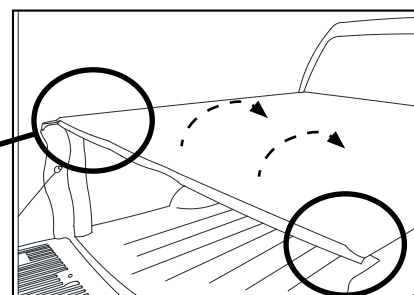
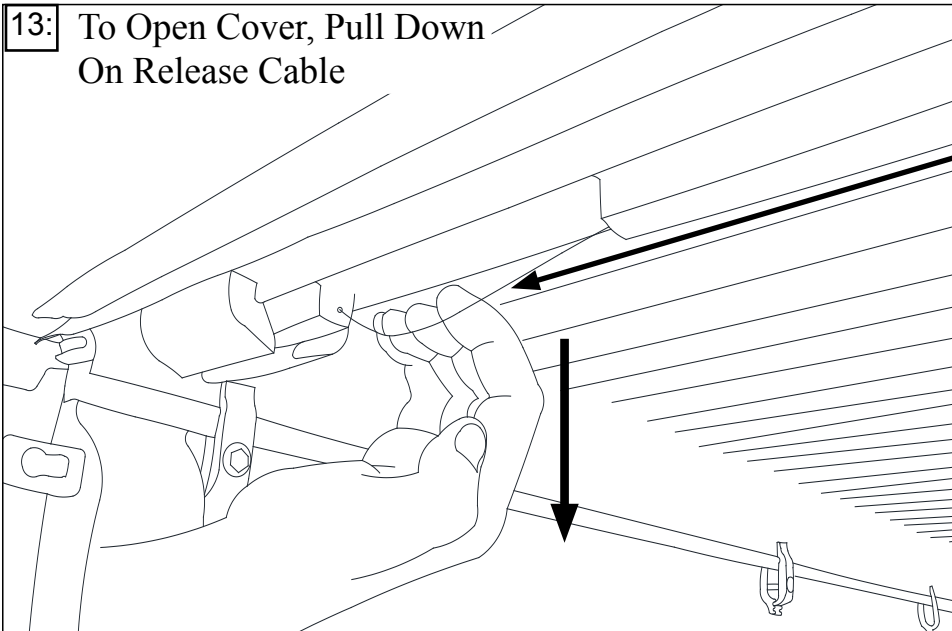

14:



CAUTION

ROLL COVER TIGHT AND SECURE BOTH SAFETY STRAPS.
DO NOT STOW COVER AGAINST CAB WINDOW.

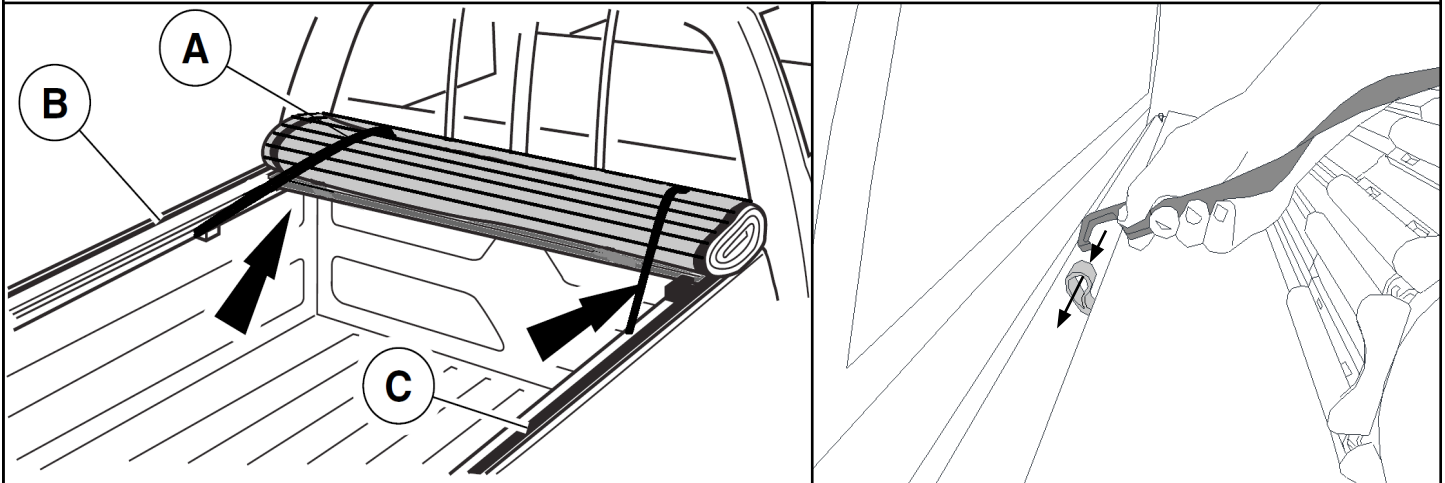

CAUTION

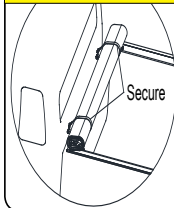

Before driving with cover open, **BOTH STRAPS MUST BE SECURED TO RETAINING LOOPS**. Failure to do so could cause accidental release of the cover, resulting in personal injury or property damage.

15: To Release Strap Push Tab Up.

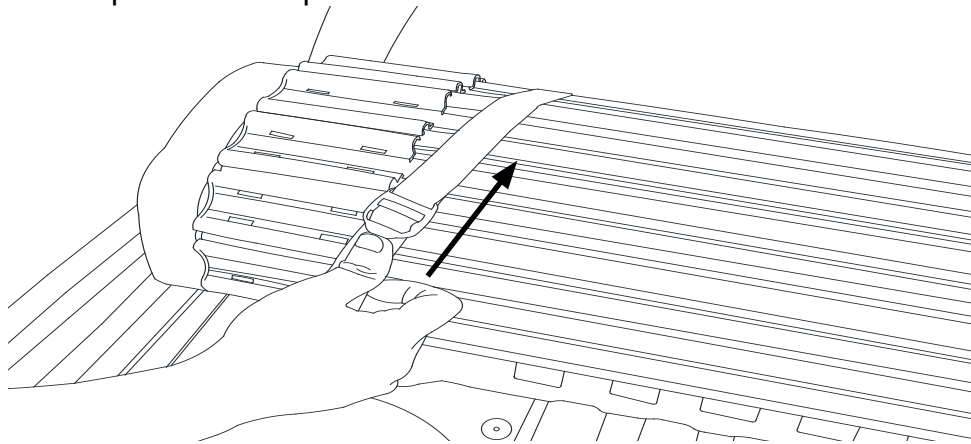

NOTICE: Ice buildup within hinge section can occur if cover is stowed in open position. To prevent potential damage, close cover during winter precipitation.

TROUBLESHOOTING

HEADER WILL NOT LATCH:

1. Check side rails to make sure they are level. See Step 5, clamp installation.
2. Make sure the rear header seal is not caught between side rail & rear header.
3. Check to make sure side rails are both equally spaced front to rear (See steps 3 & 4).
4. Make sure both latches are functioning properly. Clean any debris that may be impeding latches, see COVER CARE AND MAINTENANCE on page 1.

COVER IS HARD TO ROLL OPEN OR CLOSED:

1. Tonneau cover **MUST** be free of foreign material including snow and ice before rolling cover.
2. Prolong cold weather will make cover fabric stiff. Move cover into sun or indoors to warm the top surface.
3. If cover has been stored in the rolled up state for a long period of time it may take few minutes for the cover to lay flat. The fabric material needs to relax to a flat state, this is normal.

Questions?

Call our friendly customer service staff
Toll Free at:

1-877-878-9336
Mon - Fri 8 am - 5 pm CST

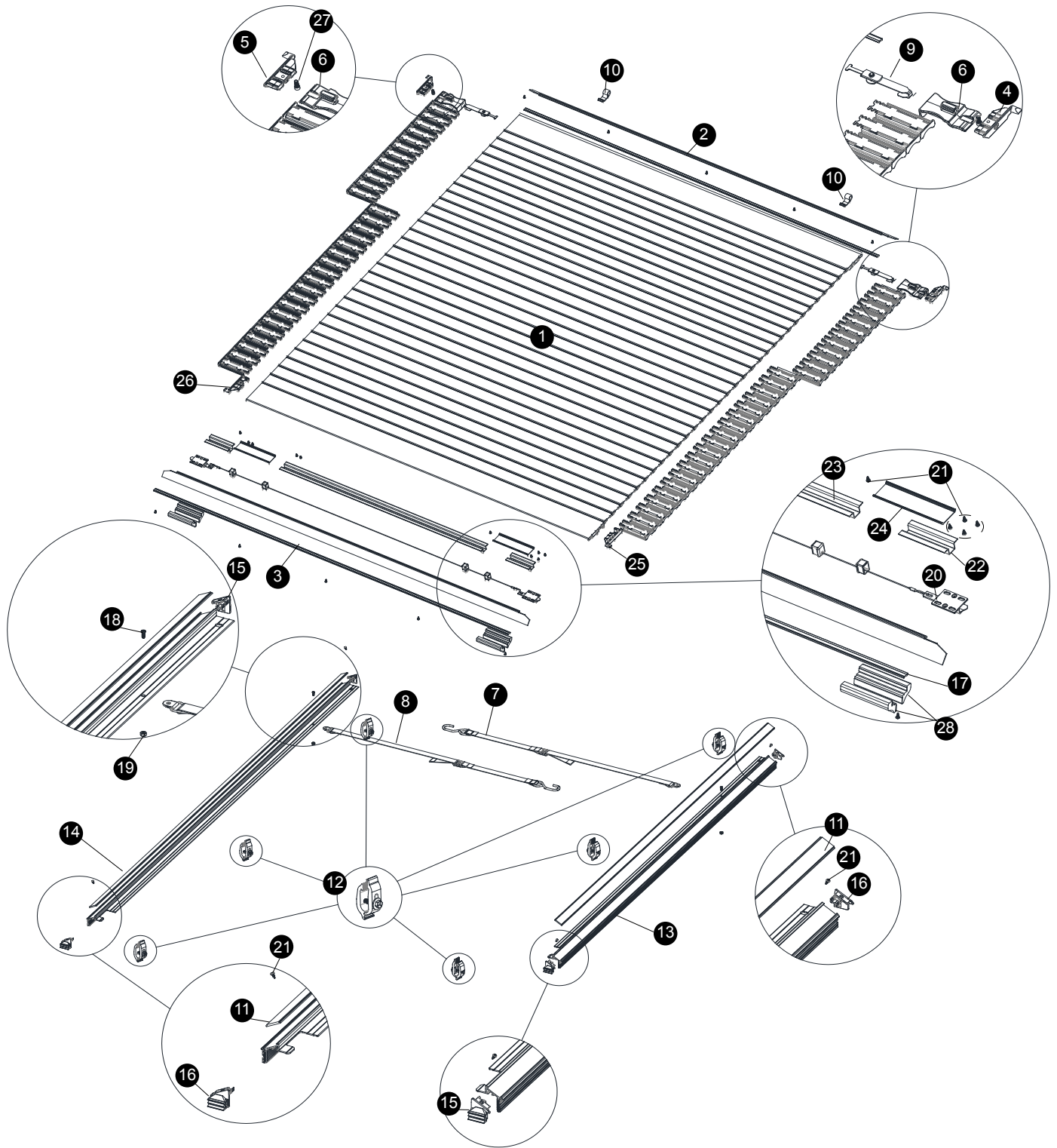

TITANIUM REPLACEMENT PARTS

- | | | | | | | | | |
|-----------|---------|-----------------------------------|-----------|---------|-----------------------------|-----------|---------|----------------------------------|
| 1 | * | Titanium Replacement Cover | 12 | 1705391 | Aluminum Clamp Assembly | 23 | * | Cable Cover |
| 2 | * | Header Seal, Notched | 13 | * | Side Rail, Passenger's Side | 24 | 1117939 | Cable Guard |
| 3 | * | Header Seal | 14 | * | Side Rail, Driver's Side | 25 | 1705349 | Rear Header End Plug (Passenger) |
| 4 | 1705338 | Front Header End Plug (Passenger) | 15 | 1705403 | Side Rail End Plug (right) | 26 | 1705348 | Rear Header End Plug (Driver) |
| 5 | 1705337 | Front Header End Plug (Driver) | 16 | 1705402 | Side Rail End Plug (left) | 27 | 1704689 | Machine Screw 1/4-20 X 9/16 |
| 6 | 1704707 | Header Guide | 17 | * | Fabric Keeper | 28 | 1705283 | Extruded Rubber Idler Spacer |
| 7 | 1117892 | Safety Strap (Passenger) | 18 | 1705415 | Cap Screw 10-24 X 1/2 | | | |
| 8 | 1117893 | Safety Strap (Driver) | 19 | 1703762 | Hex Nut 10-24 | | | |
| 9 | 1117594 | Header Guide Retainer | 20 | * | Latch System | | | |
| 10 | 1704715 | Extruded Retainer Loop | 21 | 1703690 | Self Drill Screw 6-20 X 3/8 | | | |
| 11 | * | Hook and Loop Fasteners | 22 | 1705377 | Cable Cover 4" | | | |

* Please specify length or make and model of vehicle.