

Installation Guide for Axial Black Projector Headlights w/ DRL LightBar for 09-14 F150

Installation Time: 30 Minutes

Tools Required:

- ✓ Flat head Screwdriver



- ✓ 1/2 inch Ratchet with 10mm socket



Installation Instructions:

1. Unbolt the Factory Headlight assembly by removing the 3 10mm screws, and the plastic screw holding the rubber flap in place.

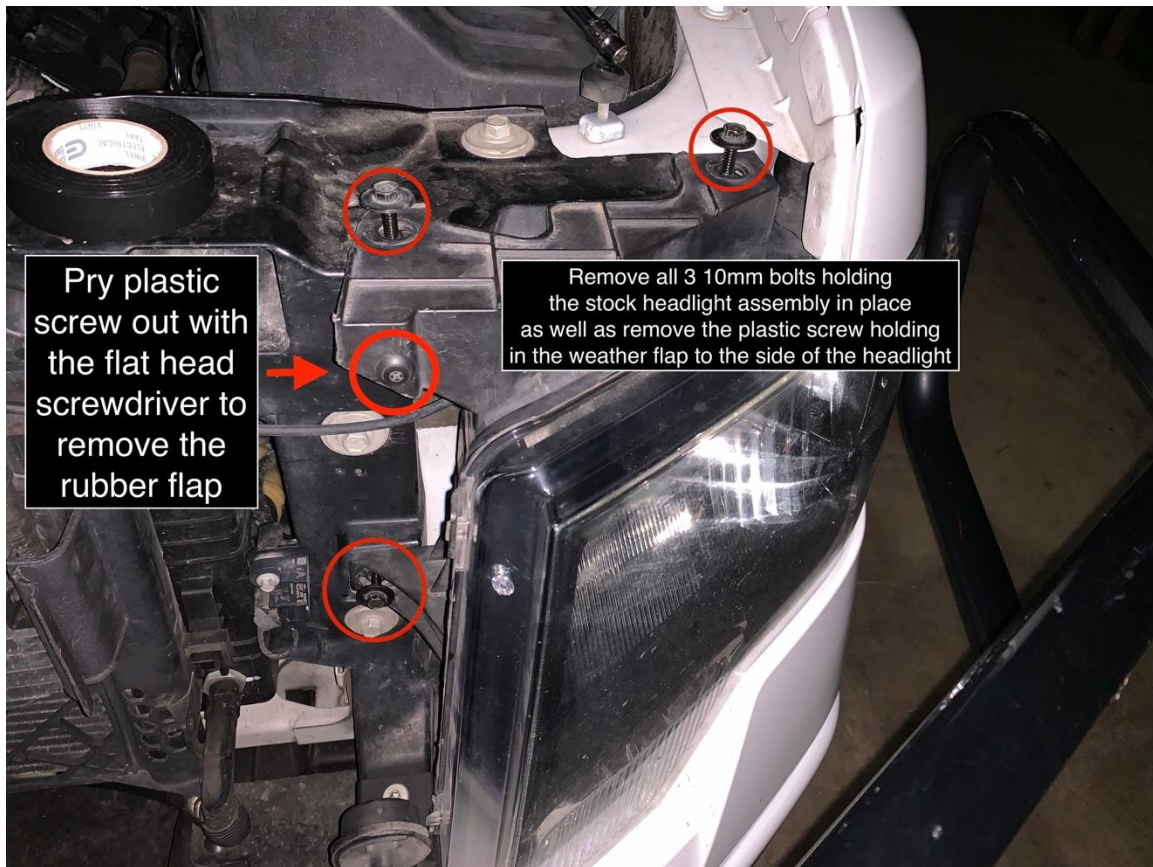

2. Pull out the Factory Headlight assembly



3. Disconnect the factory wiring from the Headlight assembly

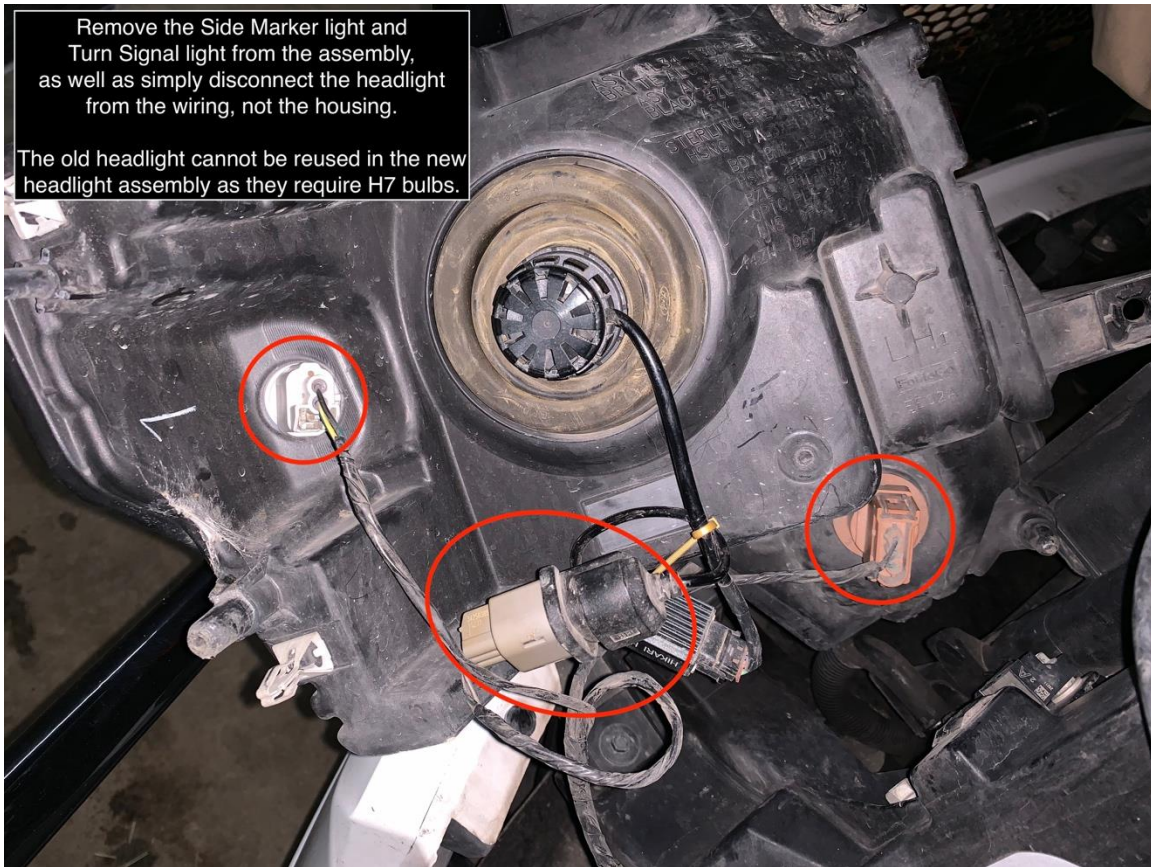

4. Remove the Factory Headlight assembly



5. Remove new assembly pair from the box



6. Disconnect factory turn signal

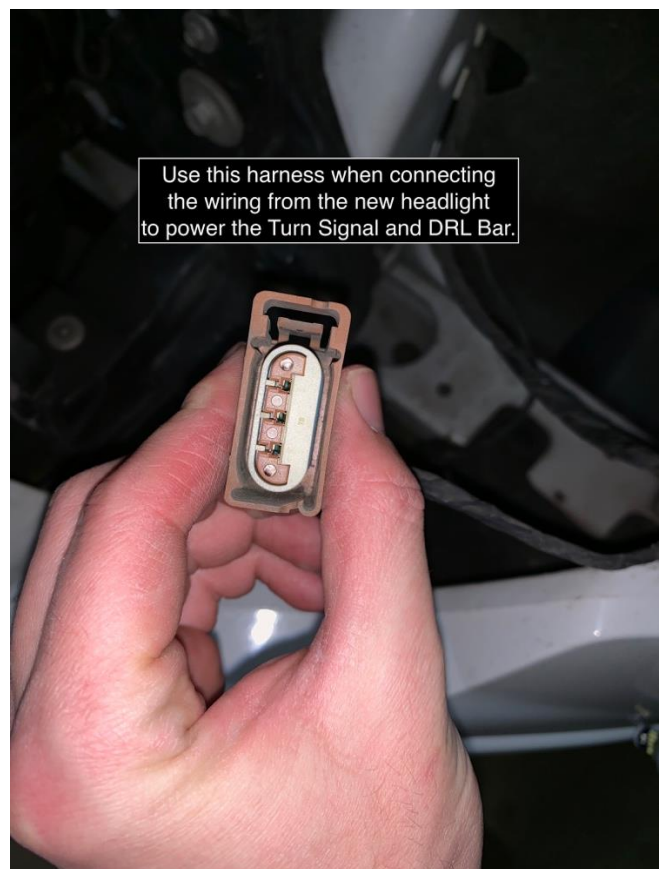

7. Plug in light wiring

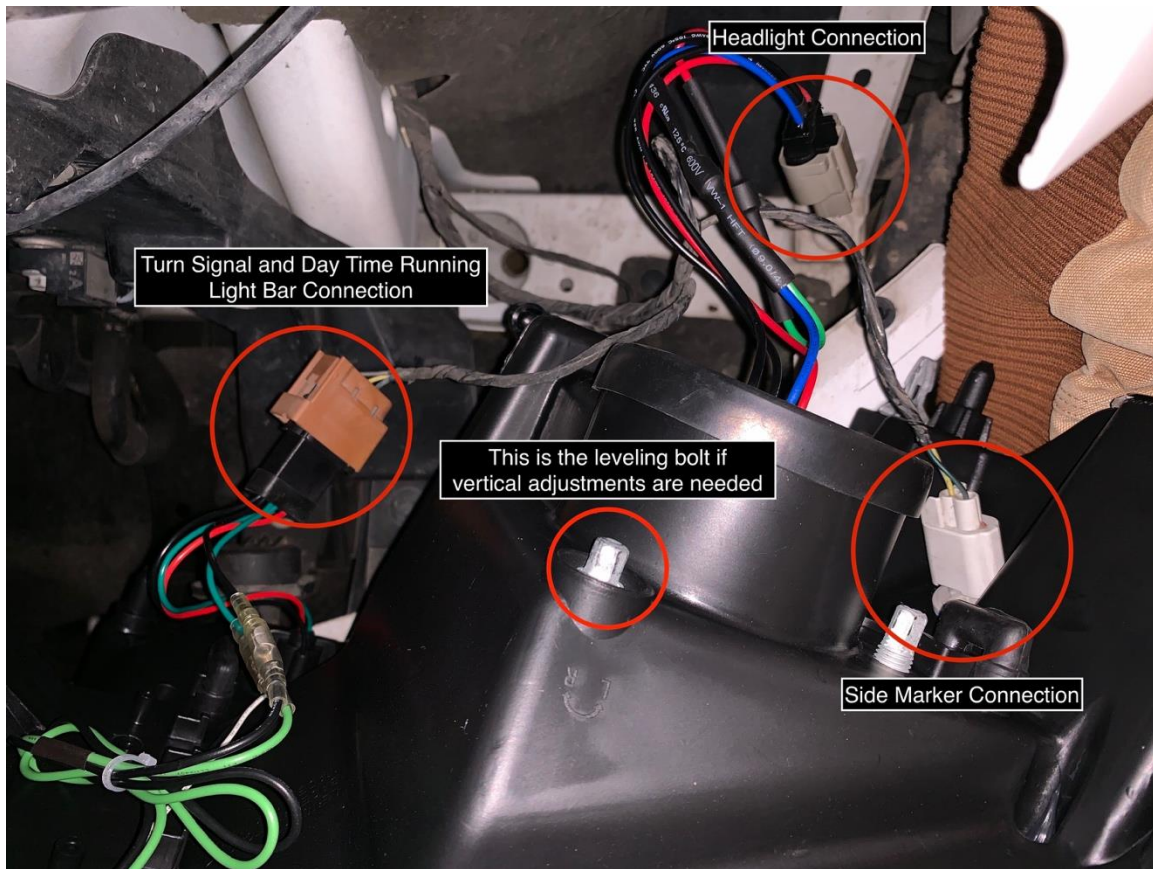

8. Reinstall 3 10mm screws

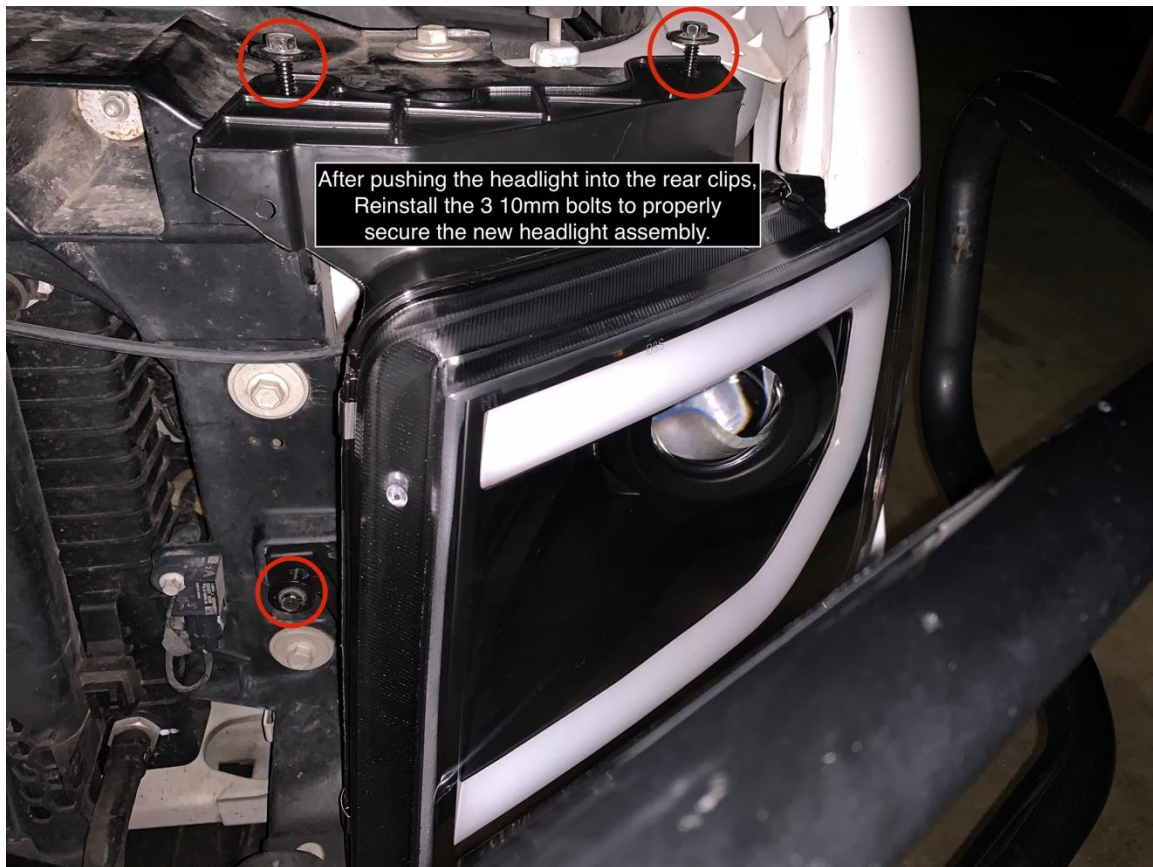

9. Test all connections



10. Repeat the same procedure for the passenger side for a finished product

